

# **Southern Regional Honors Council**

46th Annual Conference  
*Honors On the Edge*

Renaissance Arlington Capital View Hotel  
April 5-7, 2018  
Arlington, VA

Hosted by  
Northern Virginia Community College

**NOVA** | Northern Virginia  
Community College

# Southern Regional Honors Council

## Executive Committee and Board 2017-2018

President, Patrick Bahls  
University of North Carolina, Ashville

Vice-President, Stacy Rice  
Northern Virginia Community College

Past President, Gregory Tomso  
University of West Florida

Past Past President, Steven Engel  
Georgia Southern University

Student Vice-President,  
Bayla Bessemer (2017-2019)  
University of West Florida

Executive Secretary-Treasurer,  
David Coleman (2017-2020)  
Eastern Kentucky University

Webpage Manager, Steven Engel  
Georgia Southern University

### At-Large Representatives

Faculty/Staff, Tai Houser (2015-2018)  
Broward College

Student, Alycea Brunson (2017-2018)  
Virginia State University

Faculty/Staff, David Kime (2017-2020)  
Northern Kentucky University

Student, Callie Elliott (2017-2018)  
Gardner-Webb University

Student, Jessa Hay (2017-2018)  
Eastern Kentucky University

### Conference Co-Chairs

Paul Fitzgerald  
Northern Virginia Community College  
John Sound  
Northern Virginia Community College

Rebecca Hayes  
Northern Virginia Community College

# 2018 Conference at a Glance

## Thursday, April 5, 2018

7:00 am-6:00 pm, Registration  
8:30 am-9:00 am City as Text™ Introduction  
9:00 am-12:30 pm City as Text™  
12:30 pm-1:45 pm, City as Text™ Group Review and “Shout Outs”  
12:30 pm-1:30 pm, SRHC Executive Committee Meeting  
12:30 pm-1:30 pm, Student Moderator Meeting  
2:00 pm-3:00 pm, Session A  
3:00 pm-5:00 pm, Artistic Exhibitions with the artists  
3:15 pm-4:15 pm, Session B  
4:30 pm-5:30 pm, Session C  
4:00 pm-5:30 pm, Poster Preview Session  
6:00 pm-8:00 pm, Dinner with Keynote Speaker, K. David Harrison  
8:30 pm-10:00 pm, “The Linguists” documentary film viewing

## Friday, April 6, 2018

7:00 am-5:00 pm, Registration  
7:00 am-9:00 am, Breakfast and Book Signing  
8:00 am-9:00 am, Partners in the Park™ Organizational Meeting  
8:00 am-5:00 pm, Artistic Exhibitions  
8:00 am-9:00 am, Session D  
9:15 am-10:15 am, Session E  
10:30 am-11:30 am, Session F  
11:45 am-1:15 pm, Lunch with SRHC General Business Meeting  
1:30 pm-2:30 pm, Session G  
2:45 pm-3:45 pm, Session H  
4:00 pm-5:00 pm, Session I  
5:00 pm-7:00 pm, VCHC Flash Talks and Recognition Ceremony  
5:00 pm-9:00 pm, Explore D.C./dinner on your own  
9:00 pm-10:30 pm, “The Linguists” documentary film viewing

## Saturday, April 7, 2018

7:00 am-9:00 am, Breakfast (grab and go)  
8:00 am-9:00am, Poster Set-up  
8:00 am-9:00 am, Session J  
9:30 am-11:00 am, Poster Presentation Session  
9:30 am-10:30 am, Session K  
10:45 am-11:45 am, Session L  
12:00 pm-12:30 pm, SRHC Closing and Reflection  
12:30 pm-2:00 pm, SRHC Executive Committee Meeting  
12:30 pm-2:00 pm, VCHC Executive Committee Meeting  
12:30 pm-1:00 pm, PITP™ Gathering for Departure

# Renaissance Arlington Capital View Hotel

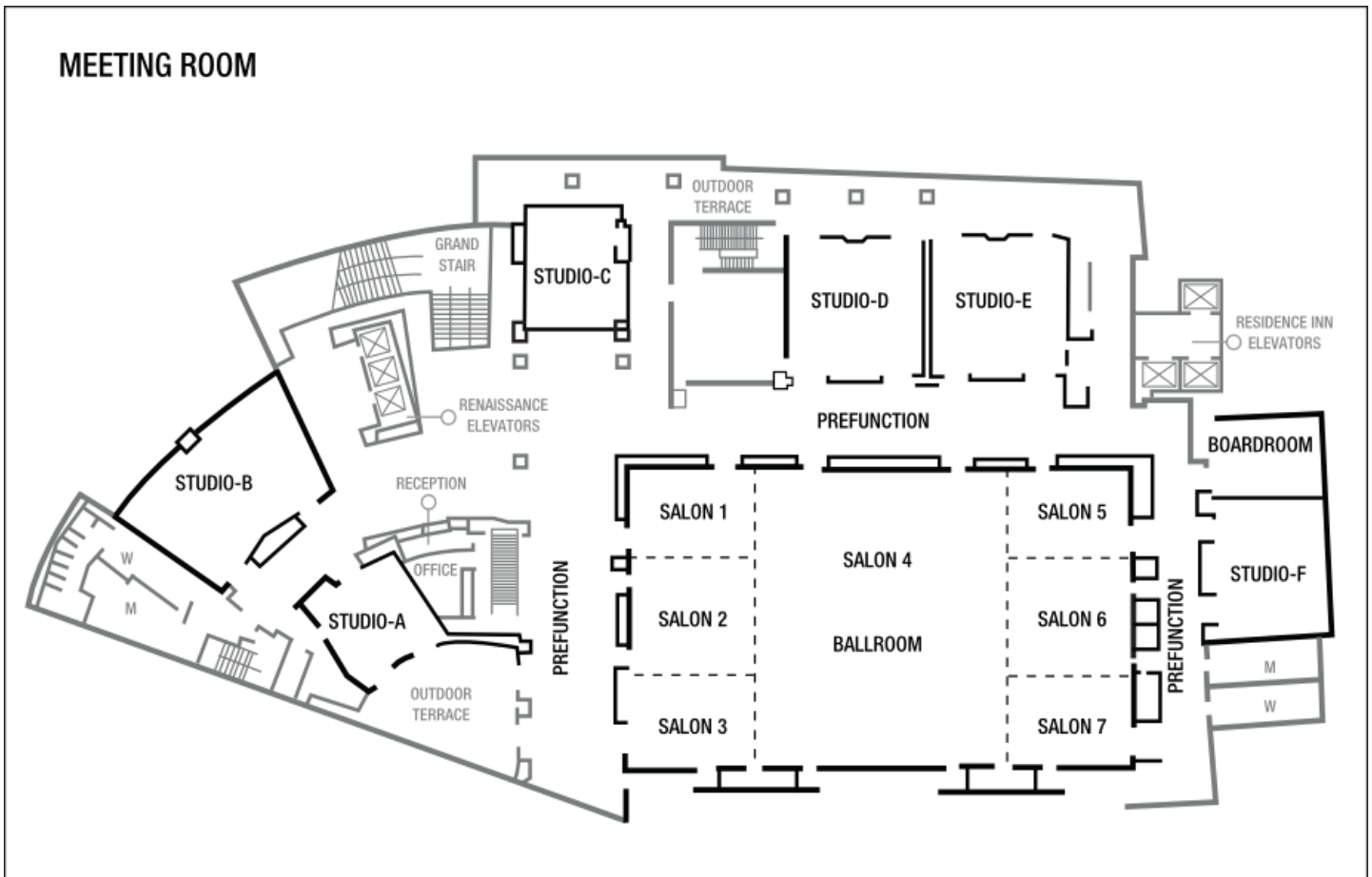

# Residence Inn Arlington Capital View Hotel



# General Conference Information

## Welcome to the Washington D.C. Metro area!

Welcome to the Nation's capital! Washington D.C. has it all: free museums, centuries-old monuments, beautiful cherry blossoms, and exquisite memorials dedicated to those who fought for our liberty and freedom. The city is full of life in every direction with world-renowned restaurants, theatres, art exhibits, and architecture that people travel the world to experience. We hope you'll take the opportunity to soak in as much of D.C. as you can and celebrate its culture and history. Just a stone's throw away "on the edge" of the city is Northern Virginia with its lush mountains, hiking trails, forests, and state parks, where animals share the environment with bird watchers, bikers, and hikers alike! Getting around the city is easy with our metro and rail system, as well as taxis and Uber. You won't be bored while you're here, and we'll ensure you have a metro pass, map, and suggestions to help you get the most out of your short stay. So get out of the hotel when you can, be smart and safe, and take it all in! Just ask the NOVA folks if you have questions.

## Oral Presentations, Research Panels, Posters, and More!

This year's conference features over 260 oral presentations, over 140 posters, and several research panels, all offering innovative insights on everything from gender theory to molecular biology. We have grouped oral presentations into sessions with similar themes so that folks coming to support one presenter will find themselves enlightened by other talks in the session. However, we encourage you to branch out and attend talks on topics outside of your own discipline. Growth takes daring and discomfort, and we hope you will challenge yourself to grow in the next few days.

## Conference Etiquette

It is courteous and expected that those viewing individual talks remain in the session rooms for the entire one-hour block to keep from disrupting other rooms/presenters, as presentations times vary from room to room. If you must leave, only do so between talks and with minimal disruption.

## Wi-Fi

Marriott Rewards members may receive complimentary in-room Wi-Fi. All others must pay to have Wi-Fi access in rooms and throughout the hotel. Talk to a hotel representative for assistance.

## Administrative Roundtables

These sessions provide faculty and administrators the opportunity to discuss various areas of administrative concern. Facilitators in each roundtable will introduce the topic and provide some insight based on their experiences. Overall, these sessions provide structured settings to share best practices.

## Conference Badges

Please wear your badge to all conference activities and for admittance to meals. If you or someone in your party is missing a nametag, please see a NOVA representative at the registration table.

## Information for Presenters

Please adhere to the timetable posted in the conference program. Moderators will assist with time keeping in all sessions. Presenters should have their presentation ready on a flash drive and arrive to their scheduled room early to load their presentation onto the computer. Any time lost in loading and accessing presentations will be taken from the presenter's speaking time. Please note there is no Wi-Fi in the presentation rooms.

## SRHC General Business Meeting and Elections

The SRHC General Business Meeting will take place on Friday from 11:45 am to 1:15 pm. Elections of students, faculty, and staff to the Executive Council of the SRHC will occur at the business meeting. Moreover, the financial report, information about future conferences, other business, and the "Roll Call of the States" will take place. The meeting is open to and attendance is strongly encouraged for all conference participants.

## A Note on this Year's Conference Theme

This year's conference theme, "Honors on the Edge," was suggested by the students from the Virginia Collegiate Honors Council (VCHC), who are sharing this conference experience. "Honors on the Edge" suggests many things to many people, and we encourage you to think about how you and your academic institution, as well as your chosen degree, honors education, and leadership are on the edge of becoming iconoclastic. The original intention of the theme was to highlight the ever-changing world we live in that constantly pushes the bar higher and raises the expectations of those who strive for excellence and innovation. Ironically, Northern Virginia Community College (NOVA) is "on the edge" of SRHC's borders, and Virginia is "on the edge" of the Nation's capital, where the bustle of the city meets suburbia. The SRHC conference, all of its dedicated members and sponsors, the student and faculty presentations, and our eloquent guest speaker, Dr. K. David Harrison, all embody the idea of pushing yourself to the edge of your comfort zone and beyond so that those around you can learn from your experiences, challenges, and research and be a revolutionary. We hope the SRHC conference is a time for you to explore beyond your expectations and embrace the diversity and unique Honors communities surrounding you. Be the change you wish to see in the world; learn from adversity; be a neighbor to everyone, even those unlike you; and embody integrity and grace despite the imperfections of our ever-growing and changing country. "Honors On the Edge" is not just a theme: it is a challenge to all of you. Don't give up, as life is long and beautiful, keep striving beyond limitations, and remember those who help you climb to new heights.

# 2018 SRHC Keynote Speaker

Thursday, April 5, 6:00 pm-8:00 pm

Dr. K. David Harrison, Swarthmore College



“Half of the world's languages are endangered and may go extinct in this century. The loss of these languages will have dire consequences not only for their speakers, but also for culture, science, and the environment. Around the world, speakers of endangered languages are mounting strategic efforts to save their languages.”

This presentation features photos and video clips of speakers of some of the world's most endangered languages from Siberia, India, the USA, and other locations and will demonstrate how indigenous activists and linguists are working to sustain languages through technology and art.

David Harrison is a linguist, anthropologist, author, and advocate for indigenous languages. He completed his BA (honors) at the American University and PhD at Yale University. In 2007, he was named a National Geographic Fellow, and he is a member of the Explorers' Club. His most recent book is *The Last Speakers: The Quest to Save the World's Endangered Languages*.



# Acknowledgements

This weekend's conference would not have been possible without the assistance of a number of people, many of whom have worked tirelessly on this conference, in advance of the event and during the conference itself, to ensure that all goes well. As this year's Conference Chair, I would like to take a moment to acknowledge the help that I've received during the past several months.

First, I would like to thank the conference organizers from the past few years for their support, guidance, and encouragement. Specifically, I would like to thank Patrick Bahls, Jennifer Vallin, Greg Tomso, Steve Engel, and Jonathan Roberts. Thank you for helping us anticipate unexpected situations, for answering our questions as they arose, and for making sure we had the answers to questions we didn't know to ask. Also, a BIG thank you goes to SRHC secretary-treasurer David Coleman for managing the complex finances of a large conference. David and I learned a lot about online payment processing. Additionally, Partners in the Park would not have been possible without the efforts of Christina McIntyre (VT) and Patrick Dawes (NOVA), as well as the CNO Canal Trail Project, NPS staff, Partners in the Park alumni, the Citizen Scientist Project, and the National Audubon Society.

We are also indebted to many people for their offers of material support for the conference. The Institutional Technology department at NOVA has graciously provided laptops and projectors in all presentation rooms, and we would like to extend a special thank you to Max Alleyne of the NOVA IT staff who will provide ongoing, on-site support for all of our A/V technology. Additionally, Patrick Bahls and Phil Frana have very generously provided poster stands and backing boards for this conference, and we thank their attendees for agreeing to share bus aisles and van seats with poster stands.

Lanyards and badges were provided by a generous donation from the National Society of Collegiate Scholars (NSCS). Please thank them when you see them! Other organizations who have supported and sponsored us this year include the National Collegiate Honors Council (NCHC), the University of West Florida, DC Internships, Student Opportunity Center, University of Mary Washington, EF College Study Tours, Radford University, Osgood Center for International Studies, Marymount University, and others.

This event also wouldn't be possible without the excellent staff at the Renaissance Arlington Capital View Hotel, especially Corissa Kochan, Donnell Washington, Katherine Burneko, and Winnie Kouoh. Also, I would like to thank Marielys Montero, Titilola White, and Andrew Gordineer at the Courtyard Arlington Crystal City/Reagan National Airport Hotel.

This conference also couldn't have happened without unending help and support from SRHC Vice-President Stacy Rice, Rebecca Hayes, VCHC President John Sound, Brian Anweiler, the NOVA Honors Committee, NOVA Printing Services, NOVA administrators and staff, and all the amazing NOVA student and faculty volunteers who have devoted their time to this event.

Special thanks to all of you. This conference would not exist without the support and participation of the member institutions and their students, faculty, and staff, as well as everyone's commitment to the importance of Honors education. Please, enjoy your time here at the conference and in the Washington, D.C. metropolitan area, and welcome to the Old Dominion, the Mother of Presidents, the Cavalier State, the great Commonwealth of Virginia!

Yours in Honors,

Dr. Paul Fitzgerald  
Honors Committee Chair, Professor of Biology, Annandale Campus  
Northern Virginia Community College

# CONFERENCE SCHEDULE

This schedule is subject to change. Please consult the Grenadine App for conference schedule updates!

**Thursday, April 5<sup>th</sup>**

## **Registration**

7:00AM to 6:00PM at Registration Desk

## **City as Text™ – Washington DC**

**8:30AM to 9:00AM in Salon 4:** Introduction to Washington, D.C.

**9:00AM to 12:30PM:** Explore the City of Washington, D.C.

**12:30PM to 1:45PM in Salon 4:** City as Text™ Group Review and Shoutouts

## **SRHC Business Executive Meeting**

**12:30 to 1:30 in Studio C**

## **Student Moderator Meeting**

**12:30 to 1:30 in Studio B**

## **Session A - 2:00PM to 3:00PM**

### **Studio A**

**RESEARCH PANEL:** *Reflections on W.E.B Du Bois*

*David Lewis's Erroneous Claim about W.E.B. Du Bois*

**Maggie Jones - Birmingham-Southern College**

W.E.B. Du Bois was a staunch activist for the rights of African Americans, and is often considered to be one for women. This paper examines the flaws within David Levering Lewis's argument that Du Bois was an adamant fighter on behalf of women.

*Du Bois' Double Vision of Women*

**Lauren Mims - Birmingham-Southern College**

W.E.B. Du Bois was an important civil rights advocate and scholar. However, his dual sided analysis of women kept him from addressing the issues that plagued women of his era. Even Today, Women still battle ignorance in the push for equality.

*W.E.B. Du Bois's Search for the Ideal Man*

**Emily Wise - Birmingham-Southern College**

W.E.B. Du Bois's writings place value on masculinity and cast men as the heroes in the battle for Civil Rights. This paper explains how his focus on men ignores the contributions African American women made to the advancing of Civil Rights.

### **Studio B**

*The Female Athlete Triad: Performance vs. Health*

### **Maeghan DePace - Auburn University at Montgomery**

What is the Female Athlete Triad? Is it underdiagnosed? Do coaches understand the Triad? Why is there a disparity between the number of cases and the availability of medical help for these athletes?

*A Gene Ahead of the Game: A Look at Sports Genetics*

### **Jessa Hay - Eastern Kentucky University**

Our genetic makeup plays a bigger role in our athletic ability in certain sports than we may think. This presentation will discuss genetics basics and then compare the genes of professional basketball players, Olympic swimmers and Olympic gymnasts.

*Non-enzymatic Acetylation and Deacetylation of HUMAN NEIL2*

### **Monica Pasala - University of South Alabama**

The base excision repair pathway is involved in the repair of oxidized DNA damage. DNA glycosylases such as NEIL2 catalyze the first step of this pathway. The objective of this project is to study the acetylation and deacetylation of NEIL2.

## **Studio C**

*Chasing Coins: The Ironman Race*

### **Dylan Matthews, Hannah Jones, Mikaila Rummage - Chattanooga State Community College**

We created and collected surveys that allowed us to draw statistical conclusions, analysis the economic impact of the Ironman, and recommend improvements.

*Analysis of 2016-17 MLS Season Data Using Poisson Regression with R*

### **Ian Campbell, Dr. Bahaeddine Taoufik - Lynchburg College**

In this paper, I present an approach to analyzing in game soccer variables like passes, shots, and time of possession using Poisson Regression. I demonstrate my methods by applying it to the MLS 2016-17 season.

*Slapping Hands and Sports Bra Tans*

### **Lynn Walsh - Lynchburg College**

An analysis of non-verbal communication in sport celebrations, looking at sport, position, and gender, as well as how the public views the athlete following his or her display.

## **Studio D**

*Collection and Analysis of Human Salivary IgA to Understand Physiological Effect of Stress on the Student Athlete*

### **Claire Dundon - Radford University**

Immunoglobulin A is an antibody found in human saliva that acts as a good indicator for stress levels. Samples from student athletes were collected to detect IgA presence. In season athletes showed higher IgA levels compared to those out of season.

*Ectogenesis: Creating life outside of the womb. Is this the future for mankind?*

### **Minah Hussain, Manjot Singh - Northern Virginia Community College**

Scientists are testing the ability of a fetus to grow outside a female's body. Artificial wombs, ectogenesis, may be the future of human development. This topic illustrates how modern medical advancements are often faced with moral/ethical dilemmas.

*Exercise performance and mental toughness in task vs. time-oriented exercise bouts.*

**Logan Evans - Lynchburg College**

The aim of this study was to examine the differences in performance in task and time-oriented running bouts with a secondary aim to examine relationships between performance and levels mental toughness.

## **Studio E**

*Increasing Engagement & Access in an International Service Learning Honors Program*

**Kenneth Goldsmith - Chattanooga State Community College**

Session participants will learn about the intentional design elements which aimed to increase access and participation for historically underrepresented students in education abroad.

*Paying the Price: Different Models for Internationalizing Honors*

**Karly Potts - Morehead State University**

I will explore various approaches to internationalizing Honors, with the goal of presenting findings that may be useful to those involved in designing and implementing international components of Honors programs.

*I Lost Both My Pinkie Toenails: How an Honors Course Sent Me to Spain*

**Carolyn Schweitz - UNC Asheville**

We explore one student's journey from an Honors classroom onto the Camino de Santiago in Spain as she rediscovers herself and her passion for learning. We will also discuss proper foot care for long distance hiking.

## **Studio F**

*The Future of Food: Recipes that Promote Sustainable Farming*

**Andrew Brown - Birmingham-Southern College**

Can a chef create cuisine that influences our food choices and ultimately our nation's food production? This project explores harmful agriculture practices and offers solutions by developing recipes that highlight sustainable ingredients.

*The Secret Life of Cows*

**Kira Breen - Georgia Southern University Armstrong Campus**

Cows destined for consumer consumption now reside in "concentrated animal feeding operation[s]." While this new system has allowed beef prices to decline, there are major repercussions in modernizing.

*Political Ecology and the Integration of Aquaponics in Costa Rica*

**Paris Smith, Cailyn Dyer - James Madison University**

Aquaculture is an increasingly popular method of food production. This paper describes a local attempt to re-establish sustainable agriculture through the development of a system that uses a naturally occurring cycle that integrates fish and plants.

## **Salon 5**

*Confucian Pedagogy*

**Allen Doyle - Birmingham-Southern College**

This is a philosophical analysis of the historical Confucius, and the pedagogy of his living-learning community of his disciples.

*The Human Condition: The nature of Man according to Confucian Perspectives*

**Kadien Hill - Georgia Southern University**

Is the nature of man inherently good or is it evil? Using the doctrines of both orthodox and unorthodox Confucian philosophies, we will expound and discuss this existential issue that has caused debate for centuries.

*The Descendants of Georg Wilhelm Friedrich Hegel's Philosophy of History*

**Jonathan Dean - Morehead State University**

This presentation will analyze interpretations of the work of Georg Wilhelm Friedrich Hegel by Karl Marx, Friedrich Nietzsche, and Francis Fukuyama, each of which altered elements of Hegel's work in ways relevant to their own historical context.

## **Salon 6**

*The Cognitive Benefits of Bilingualism*

**Alexis Berles - Coker College**

It is common knowledge that bilingualism is an advantage to everyday life. Less common are the cognitive benefits of bilingualism, which can begin in infancy and be sustained into adulthood and even delay cognitive decline that comes with age.

*Implementation of Bilingual and Bicultural Education Programs*

**Mariah Cox - Murray State University**

This research proposes bilingual education programs as a valid option for improving disparities in privilege between ethnic majorities and minorities. It then attempts to explain how these programs can be implemented through college students.

*Benefits of Being Bilingual in the Modern World*

**Rodrigo Giron, Gregory Paredes - Northern Virginia Community College**

The focus of our presentation will be highlighting the benefits of being bilingual in the modern world. Through physical data, we will show that being able to handle a language other than English can be crucial to being successful today.

## **Salon 7**

*An Undergraduate Defense of Chaucer's Constance and Parson*

**Taylor Cielo - Catawba College**

Although most of Chaucer's tales are praised, two are often cited as lapses in his skill: "The Man of Law's Tale" and "The Parson's Tale." This presentation argues why neither are actually failures, and what Chaucer's true intent in writing them was.

*Trickster Figure in African Literature: Smiling Through the Pain or Sticking it to the Man*

**Johnathan Beckett - Norfolk State University**

Many stories passed down orally have a trickster figure present. This presentation covers the African origins of the trickster and his/her contemporary incarnations in poetry, music, and the other arts.

*Velvet, Furs, and Turkish Trousers: The Role of Fashion in Subverting and Reaffirming Binaries in Orlando*

**Lauren Croteau - University of Tennessee at Chattanooga**

In Virginia Woolf's novel Orlando, fashion allows Orlando to both subvert and reaffirm gender norms. However, she would not be able to do this were it not for her class status and her use of orientalism and racism to reaffirm her identity.

## Art Exhibition

3:00PM to 5:00PM in the Terrace Room

*"As If..."*

**Alex Capri - University of Alabama, Birmingham**

*A realistic charcoal drawing portraying a woman staring directly at the audience - meant to provoke introspection and self-awareness of the viewer.*

*Ennui*

**Hannah Bae - University of Alabama, Birmingham**

*Ennui is a surrealist painting of a man with the head of a bird. He reads a book with no words, standing alone in a bleak, unidentifiable landscape. There is no contact between him and the audience; he engages only with the blank book.*

*Citrus in my skin*

**Hannah Bae - University of Alabama, Birmingham**

*Citrus portrays a person with yellow skin, profile against a blue-grey background. This painting is intended to be a piece commenting on some of the most prominent stereotypes and issues that Asian-Americans face today.*

*Roses and Razor Blades: Artistic Representations of Social Stigma and Mental Illness*

**Laurel Edge - Catawba College**

*Roses and Razor Blades is a collection of visual art pieces, which address the social stigmas associated with mental illness. All of the images were inspired by my personal experience as well as my observations of prejudice, pain, and conflict.*

*Adventures of Honu the Duck*

**Amelia Kahle - James Madison University**

*This exhibit features photographs of a vibrant rubber duck named Honu. Taken in various locations, these images constitute a series that is featured on Instagram. Honu is a symbol of adventure and joy and is my favorite subject to photograph.*

*The Shapes Of Perception*

**Iris Wynn - Southeast Community and Technical College**

*It is no exaggeration to say the world and its colors aren't perceived the same by every person. I hope that by seeing the illustrated depictions of the world i have created along side our own will encourage you to seek out your own perception.*

*Cell Biology as Art*

**Emily Martin, Candace Ashworth, and Dillon Richardson - Shenandoah University**

*We each created a piece of art that demonstrates a biological concept. While each piece can be viewed solely as a piece of art, each also demonstrates the role of art in portraying science and biology concepts to both peers and the general public.*

*Hindemith Flute Sonata: Pushing the Edges of the Flute's Range*

**McKenzie Garrett - Eastern Kentucky University**

*Paul Hindemith fit very well into the idea of living on the edge. He was a German composer during World War II. He was under the constant threat of being put into a work camp. He was also a part of the music world's transition into the modern era.*

*Est. 1873: An Illustrated History of Martin, Tenn.*

**Rachel Melton and Sarah Haig - University of Tennessee at Martin**

The project highlights historical information central to Martin, TN and renews it in a contemporary design style through a research-based process. It is the hope of the artist to build an appreciation for design as a way to preserve local history.

## **Session B - 3:15PM to 4:15PM**

### **Studio A**

*RESEARCH PANEL: Analysis of Admissions Process: JMU Honors College*

**Devin Boehmer, Sarah Boelsche, Jared Diener - James Madison University**

This project reflects an in depth study of the process of admission to the JMU Honors College, utilizing internal data as well as feedback from thirteen other honors colleges in the United States.

### **Studio B**

*Real Life Zombies*

**Safa Ishaq - Northern Virginia Community College**

What if the zombie apocalypse became a reality? Flakka is a synthetic drug that creates real life zombies. The chemistry of this new form of bath salts effects the brain to induce zombie-like behavior in its victims.

*Making the Most of the Network Data We Have: The Robustness of Efficacy for Targeted Immunization Strategies*

**Samuel Rosenblatt, Jeffrey Smith, G. Robin Gauthier - St. Mary's College of Maryland**

We develop a method to test the efficacy of targeted network immunization strategies under the assumption of incomplete network data—testing how the statistical robustness of network measures affects the efficacy of the strategies that utilize them.

*Fishing for fertility: Using a substrate trap to isolate novel fertility-governing proteins*

**Autumn Graves, Dr. Chris Trzepacz - Murray State University**

We propose to create a foundational map of the fertility-governing PAM-1 aminopeptidase mechanism by identifying PAM-1 specific substrates in *C. elegans* using affinity chromatography, SDS-PAGE, and mass spectroscopy.

### **Studio C**

*The Longest Hatred: Setting the Stage for Anti-Semitism in early 20th Century America*

**Jared Mark - Appalachian State University**

The roots of anti-semitism continued to grow throughout the world during the early 20th century. This presentation will examine the relationship between Yiddish theatre and the oppression suffered by Jewish immigrants between 1900 and 1925.

*The 1492 Jewish Expulsion: An Economic Perspective*

**Michelina Restaino - Georgia Southern University**

In 1492, King Ferdinand and Queen Isabella expelled the Jews from the Spanish kingdoms. This project explores the economic reasons behind why the expulsion happened and asks why it was aimed only against the Jewish people.

*Burying Berlin: How Germany Cleaned Up Anti-Semitic Laws in Preparation for the 1936 Berlin Olympics*

**Hope Matherly - Greenville Technical College**

The early anti-Semitic laws in Germany, along with a Nazi regime that hid its racial cruelty and displayed only its best and brightest at the 1936 Berlin Olympics, helped reshape other nations' views about Germany just prior to World War II.

## Studio D

*Civilizing with a Krag: U.S. Counter-Insurgency in Vietnam and Iraq*

**George Ritchie - Augusta University**

This presentation examines and compares the effects of counter insurgency operations in Vietnam and Iraq, arguing that focusing on the hearts and minds of the locals is more effective than conventional strategies.

*The Vietnam War Hero: Analyzing Tim O'Brien's Ambiguous Delineation of Heroism and Cowardice*

**Julianna Schock - Birmingham-Southern College**

This presentation examines Tim O'Brien's *The Things They Carried* and argues O'Brien redefines heroism by blurring the delineation of heroism and cowardice due to the Vietnam War's ambiguous motivations.

*The Policies of Agent Orange*

**Madison Bingle - Coker College**

The purpose of this honors thesis is to explore the policies of the American and Vietnamese governments in combating the legacies of Agent Orange. It is crafted from a collection of legal & congressional documents, scientific research & anecdotes.

## Studio E

*The Future is Female*

**Alajia Colon - Georgia Southern University**

Women are getting more jobs, better salaries, and are acquiring more degrees than male counterparts across the globe. However, there is still inequality of representation, especially in the STEM field. The path to change begins with our young girls.

*The Women's Rights Movement in Britain and France during the 19th and 20th Centuries*

**Emma Hodges - Greenville Technical College**

The women's rights movement in Britain and France led to equal rights for women, the right to vote, and other reforms in the 20th century due to the hard work and dedication of several key suffragettes.

## Studio F

*Mathematics Education Through College Algebra and Calculus*

**Bailey Kirk - Georgia Southern University**

Faculty conducted assessments on College Algebra and prerequisite skills for Calculus. This presentation shows the trends within the data that can be used to improve the teaching and learning of concepts in College Algebra and skills for Calculus.

*Synthesis of Au Nanorods with Pd<sub>4</sub> Peptide-capped Pd (Pd@CPd<sub>4</sub>) Nanoparticles Functionalization for Suzuki Coupling Reactions*

**Tyler Wagner - Georgia Southern University**

Suzuki coupling is a reaction that allows coupling between boronic acids and aryl halides using a Pd catalyst. Although this reaction does not work with chlorinated substrates, it should be more favorable when using Pd@CPd<sub>4</sub> Au nanorods as a catalyst.



*Zeta and Gamma functions*

**Khachatryan Elen - Randolph-Macon College**

Riemann Zeta function trivial zeros will be calculated with some aid from Riemann functional equations, which will initially be proved. Some results that will be used in proving the functional equations will touch Beta and Gamma functions.

## Salon 5

*Nigerian Terror: The Rise of Boko Haram*

**Kelly Moss - James Madison University**

This study seeks to identify the causes of the Boko Haram insurgency in Nigeria and analyze domestic and international responses to the terrorist group up to present day. It concludes with policy recommendations to counter the organization.

*The Armenian Genocide, a Contested Memory*

**Lauren Pina - Norfolk State University**

Opposing ideas, about dynamic events in societies, may lead to contested memories about the historical characteristics of those events. Historical facts may be distorted by collective memories. Contested memories genocide continue to shape the relationship between the Armenians and Turks.

*Adversity and Anguish: Enduring Hardship and Famine During 1982-1986 Ethiopia*

**William Garrett - University of Tennessee at Chattanooga**

The Great Famine of 1982-1986 had a devastating impact on the entirety of Ethiopia, but this historical fiction piece will attempt to understand the plight of the Ethiopian peasant on an individual level.

## Salon 6

*Thou art Slave to Fate: Authors and the Divine*

**Abigail Birkhead - Catawba College**

Fascination with the idea of fate has been present in works of literature throughout time. This presentation will explore the role of fate in an array of authors' poetry and prose, both old and new, and how it may reflect their own personal beliefs.

*Secular and Religious Medicine in Ancient Civilizations*

**Grace Powers - Georgia Southern University Armstrong Campus**

For many ancient civilizations, limited medical knowledge left early peoples with a simple understanding of the world, leading many to turn to religion. Thus, religion varyingly influenced many facets of a civilization, including medical ventures.

*It's Not the Science, It's You: A Psychological Approach to Anthropogenic Climate Change*

**Mia Dadian - UNC Asheville**

97% of active climate scientists agree that climate change is anthropogenic, and yet we still are debating whether or not climate change is happening. We will take a psychological approach to answer why we continue to debate climate change.

## Salon 7

*Silence as a Strategy*

**Jarvis Steele - Georgia Southern University**

Martin Luther King Jr. had a dream, but so did Huey P. Newton. There are many different ways to combat injustice. If there is value in the blur of noise we call protest, why not in the simplicity of clearly articulating through silence?

*The Role of Education in Post-Conflict Stability*

**Alexandra Wilson - James Madison University**

This brief argues that post-conflict states require both national security and reinvestment in civil society for reconciliation. Using education as a compliment to national security augments stability by overcoming barriers to reconciliation.

*Resistance without Restraint: Civil Disobedience in Vietnam*

**Zeke Starr - University of Tennessee at Chattanooga**

Civil disobedience is viewed as playing a central role in changing public opinion about the Vietnam War. This presentation weighs the empirical and theoretical conflict over that role.

## **Poster Preview Session**

**4:00PM to 5:30PM in the General Meeting Space**

### **1) Identifying Subjective Value in Women's College Golf Recruiting Regardless of Socioeconomic Class**

Victoria Allred - East Carolina University

*Junior golf ranking systems have a bias based on socio-economic backgrounds. Analyzing junior girls' golf statistics, has led to the creation of an objective methodology to compare players.*

### **2) Benefits of Music Education**

Tiffany Bartholomew - Pfeiffer University

*Students have an increase in brain development when they have studied music throughout childhood. Musically gifted students have enhanced learning skills and have the potential to excel in many areas inside and outside of the classroom.*

### **3) Identifying Candidate Genes Involved in Syndromic and Non-syndromic Intellectual Disability in Consanguineous Pakistani Families**

Jason Brown - Augusta University

*DNA from five consanguineous Pakistani families with ID was used. Homozygosity mapping provided candidate regions within the chromosomes. A review of current literature was performed, identifying 36 candidate genes among the identified regions.*

### **4) Analysis of the 756 Novel Small RNAs In Salmonella**

Donavon Dahmer - University of South Alabama

*The Borchert lab published work last year identifying 58 entirely novel sRNAs involved in regulating the Salmonella carbon starvation response. Utilizing past methods with new info, we have identified and validated 756 entirely new Salmonella sRNAs.*

### **5) Self Defense of Abies fraseri via Organic Secondary Metabolites**

Taylor Darnell, Dr. Laura Grochowski, Dr. Tim Durham - Ferrum College

*By analyzing the compositional terpenoid differences between healthy and unhealthy Abies fraseri trees, quantification of those differences will be measured to assess the effectiveness of biological mite control.*

### **6) The Importance of Public Lands for Community Well-being and Sustainability**

Chelsea deRochemont - James Madison University

*Accessible public spaces promote the social bonds necessary for the development of a global, intergenerational environmental ethics. They impact physical and emotional health, promote community and social awareness, and foster community well-being.*

### **7) Reliability of Clustering in Forecasting Stock Prices of Companies Traded on the Stock Exchanges**

Shristi Dhakal - Mississippi University for Women

*This project determines the degree of reliability of the clustering strategy in accurately and consistently forecasting the future stock prices of companies traded on the stock exchanges by analyzing the financial statements of sixty tech*

companies.

### **8) An Energy Crisis: Lethal Solutions**

Sophia Fleri - Georgia Southern University

*Solar fields can threaten nearby wildlife. Solving one environmental problem delivers another.*

### **9) How Strange: A Look at Project MKUltra Through the Eyes of Stranger Things**

Jessa Hay - Eastern Kentucky University

*Hawkins National Lab from Stranger Things is a parallel of the CIA and their experiments entitled "Project MKUltra." The goal was to develop mind-control techniques with psychedelic drugs and we see this portrayed in the show by the character Eleven.*

### **10) Custody Reform: Improving the System for the Best Interests of the Child**

Natalie Hurst - University of Tennessee at Chattanooga

*The Best Interest of the Child rule, a standard used in custody cases, is flawed. The Approximation Rule is an alternative. Using psychological data, I add parts from both rules to help judges decide the best solution for the children involved.*

### **11) An Analysis of Social Facilitation: How an Audience Affects Performance**

Kaley Hyatt - Pfeiffer University

*To grasp the phenomenon of social facilitation, analyzation of sport dynamics, airport screenings, and eating disorders was accomplished. Through this, the evolution of the psychological topic is shown as Triplett's initial idea is altered over time.*

### **12) Race in advertising: Skin color's effect on perceived value**

Devin Jones - Radford University

*Does skin tone in an advertisement affect perception of product value? This research examines whether a consumer's preconceptions about race influence an individual's perceived value of a product.*

### **13) Cytotoxic Evaluation of a Chalcone Derivative Library on A549 cells**

Mary Elaine Kuo, Amanda Krzysiak - Bellarmine University

*A variety of molecules examining the flexibility and confirmation of the chalcone were screened for their potential to affect cellular proliferation of lung cells. We found that constraining the ring has negative effects on biological activity.*

### **14) Single or Taken: The Effect of Relationship Status, Gender, and Interaction with the Opposite Sex on Arousal and Spatial Ability**

Kylie McGee - Gardner Webb University

*This research discusses the effect that relationship status and interaction with the opposite sex has on nervous system arousal and spatial ability.*

### **15) The Effects of Chronic and Binge Ethanol Feeding and Kratom Consumption on Liver Dysfunction in Male C57BL/6 Mice**

Carsyn Patton, Kinae Ogle, Kayla Bonilla, Tracy Davis - Wingate University

*Mitragynine, an alkaloid of Kratom, has shown positive side effects along with reports of hepatic injury. This study aims to determine the effects of Kratom and Kratom plus ethanol. It was hypothesized that Kratom would exacerbate liver dysfunction.*

### **16) The effect of sleep on a collegiate women's basketball team's injuries, illnesses, RPE, and scoring percentage**

Lindsay Perrin - Georgia Southern University

*Basketball season occurs over several months and allows for little recovery time. The majority of the time, college athletes do not receive the proper amount of sleep which is believed to hinder their recovery process and affect their health as well as their success on the court. But does it?*

### **17) Gene Therapy**

Austin Phillipson, Jadd Ahmad - Broward College

*This presentation will be on gene therapy, it will consist of five portions, history, applications, risks, benefits, and the process used for gene therapy.*

### **18) Implicit Biases of Oncologists Affecting the Treatment of Black Cancer Patients in the United States**

Kush Shah - Virginia Commonwealth University

*I proposed methods for oncologists to increase their awareness of implicit bias and their susceptibility to their own along with methods to reduce their cognitive stressors. The next step is to implement these methods with actual oncologists.*

### **19) The Correlation between Personality and Music Preferences**

Barbara Walas - Northern Virginia Community College

*The major purpose of this study was to investigate the correlation between the particular personality traits (extraversion and introversion) and the music preferences among people. Significant correlation was found for 4 out of 15 music genres.*

### **20) Peer Education to Pre-licensure Nursing Students: How Electronic Health Records Impact the Patient, Nurses, and the Organization**

Tessa Wilkins - Georgia Southern Armstrong Campus

*The purpose of this project is to explain how peer education from health informatics students can help pre-licensure nursing students be better prepared to encounter and utilize EHRs to benefit patients, themselves as nurses, and the organization.*

### **21) Creativity in Science: Analysis of Science Portrayal in Popular Culture**

May Zaw, Michelle Lapak - University of West Florida

*This study analyzed media in popular culture to identify potential sources that can be used in the classroom to foster the nature of science. If shown that science is a creative effort, this may foster interests in the STEM field by the students.*

### **22) Student Entrepreneurship: A hot pursuit of passion or a demand from economic stress?**

Andrew Herrington, Lauren Fleming - Columbia College

*In the last decade, student entrepreneurs have found a creative mind and flexibility are more than advantageous but necessary. We will display research showing the need for student entrepreneurship as students enter a faulty economy.*

## **Session C - 4:30PM to 5:30PM**

### **Studio A**

**RESEARCH PANEL: Sounds of Silence: Music as Voice for the Oppressed**

**Emily Fogleman, Dustin Chapman, Hannah Addair, Angel Paez - Catawba College**

Music is often used to inspire people to work for social justice and equality. This panel will showcase students' research on the connection between music and social movements. Several blues songs inspired by this research also will be performed.

### **Studio B**

*The Central Focus of the Italian Catholic Church: A Study of Altars and Altarpieces in Rome, Venice, Bologna, and Florence*

**Angela Petulla - Birmingham-Southern College**

Roman Catholic altars and altarpieces during the 16th and 17th centuries had several similarities amongst them, including the dedications, the patrons, the contractual processes, and the religious significance behind each element.

*"Out of Sight, Out of Mind: Examining Gender Representation in Savannah's Historical Markers"*

**Linnea Ryan - Georgia Southern University Armstrong Campus**

The historical markers in Savannah, Georgia share some of the state's oldest history. However, research shows that there is a gender imbalance in the markers, and that women and their contributions are not being represented in the city.

*Havana: A City Reflected in its Architecture*

**Ashley DeGennaro - University of Tennessee at Chattanooga**

There are two cities of Havana, Cuba. One has preserved architecture for tourists and the other has decrepit complexes for residents. The city is challenged to increase revenue while providing safe living conditions for the people that live there.

## Studio C

*ADMINISTRATIVE ROUND TABLE: Should I Stay or Should I Go? Retention in Honors*

**Kirsten Bartels - Northwestern State University Louisiana Scholars' College; Patrick Bahls - University of North Carolina, Asheville; Colleen Reese - Northwestern State University Louisiana Scholars' College; Jeff Chamberlain - University of North Florida**

A discussion of multiple perspectives on the myriad of issues relating to Honors retention. Students, faculty, & administration investigate perceptions of honors: good & bad, and discuss why students leave, why they stay, and what to do.

## Studio D

*A Cultural-Linguistic Analysis of Stereotypical Representations of Hispanics in the Media*

**Emily Pressler - Georgia Southern University**

This presentation aims to linguistically and culturally investigate several Hispanic stereotypes as shown in selected films and TV shows from various Spanish-speaking countries, including the United States.

*Latino Cultural Representation on the Broadway Stage in West Side Story and In the Heights*

**Jordan Reich - Northwestern State University**

The portrayal of Latino immigrant experiences on Broadway can be seen with West Side Story (1957) and In the Heights (2008). It is important to analyze the background and development of each to see how Latino representations have progressed.

*Latinos in Higher Education: Overcoming Barriers to Increase Retention Rates*

**J. Brandon Dunford - Radford University**

Latino students face barriers when it comes to matriculation and retention. This presentation will examine support services offered at universities with large Latino populations and recommend increasing services at schools with smaller populations.

## Studio E

*The Dissection of the movie, "Get Out"*

**Devayne Troy - Miles College**

This presentation will focus on and dissect the themes and concepts presented in the movie, "Get Out". Particularly, negrophilia's contributions to the retrograde of African American societies instead of fortifying a community relationship beneficial to all participating social constructs.

*An American Paradox: Overproduction and the Food Insecure*

**Rachael Rainey - University of Alabama at Birmingham**

Americans waste around 40% of all food each year while many people struggle with food insecurity. This discussion will delve into factors of food overproduction and waste to explore ways to decrease food waste and help the food insecure.

*Soul Food: The Persevering Story of an Enslaved People*

**Kalah Vance - University of Tennessee at Chattanooga**

Soul food is a rendition of West African food practices adapted by slaves in order to maintain their food culture in foreign territory. My study tracks the adaptations and practices made by slaves that are still applied in soul food cooking today.

## **Studio F**

*Jobs Moving Overseas: Offshoring in the Right or In the Wrong*

**Brandon Saridjo, Anthony Ballestas, Gabriel Dos Santos, Alejandro Tapia - Broward College**

Our Group presentation of four for our Principles of Economics course (group size established by our professor) is an examination of the Economic Ethics of Offshoring.

*Nerds Abroad: A Semester Spent in Florence*

**Hayden Corley, Alice Byrd - Gardner-Webb University**

While many art history classes are taught at Gardner-Webb, none go to see art in its intended venue. This presentation will outline the importance of seeing art in its original place and how that helps one gain a deeper understanding of the culture.

*A Film Crew and Folklore Along the Indus*

**Furqan Bin Amjad - Northern Virginia Community College**

I am the executive producer of a film that examines the folktale of Heer-Ranjha. The movie dissects Heer's feminist traits and contrasts her with the modern-day women. I will also discuss my experience shooting this film in Pakistan.

### **DINNER WITH KEYNOTE SPEAKER**

**6:00PM to 8:00PM in Grand Ballroom (Salons 1-7)**

### **FILM VIEWING – “The Linguists”**

**8:30PM to 10:00PM in Studio B**

# Friday, April 6<sup>th</sup>

## Registration

7:00AM to 5:00PM at Registration Desk

## Breakfast and Book Signing

7:00AM to 9:00AM in Salon 1-4

## Partners in the Parks™ Planning Meeting

8:00AM to 9:00AM in Salon 5-7

### Session D - 8:00AM to 9:00AM

#### Studio A

*RESEARCH PANEL: Leadership on the Edge*

**Emma Fannin, Sofia Stamatiadis, Kelly Murphy, Alexandra Paladian - Cleveland State Community College**

Each presenter on this panel will describe their leadership project, the two or three principles that were most relevant to their work, and how the idea of transformational leadership impacted their project.

#### Studio B

*The Impact of Social Media on Your Personal life*

**Nataja Reece - Miles College**

Our paper discusses the pros and cons of social media. Social media can be helpful if you use it correctly, but today, people are using it to hurt others. Social media was made for social reasons, and not for bullying purposes. Some pros would be that social media can help us keep in contact with old friends, and to know what is going on in the world. Leading the cons would be not being able to get a job due to damaging and incrementing posts, having low self-esteem, and drama. This paper documents how social media can impact lives.

*Examining Socioeconomic Status as a Moderator between Social Anxiety and Drinking Behaviors in Traditional College Students*

**Kindred Carrier - University of North Georgia**

Individuals cope with social anxiety through many means, and unfortunately one pervasive way is with alcohol use. By collecting data from 196 undergraduates, researchers attempted to determine the role of socioeconomic status in this relationship.

*SlutWalks: Parody of Protest?*

**Isabella Torres - University of West Georgia**

In my paper, I will be exploring whether or not SlutWalk marches are in helping women regain their Subjectivity in the world.

#### Studio C

*RESEARCH PANEL: Faces of the Border*

**Cassidy Woosley, Lisa Wier, Calvin Andries, Samantha Tamplin, Lucinda Burkhart – Eastern Kentucky University**

This interactive presentation documents the research and personal accounts of ECU Honors students in their Sidewalk-U class in Nogales. The presenters take on different personalities to portray first-hand accounts they witnessed while on their trip.

## Studio D

### *Pinned to My Cork Board*

#### **Kaycee Aultman - Abraham Baldwin Agricultural College**

In my bedroom, one of the entire walls is covered in a giant cork board. After almost five years of pinning things on it, the board has become a physical representation of all the things that make me who I am.

### *Jocks Can Still Be Nerds*

#### **Jessica Ferguson - Gardner-Webb University**

A panel consisting of members of the Gardner-Webb women's soccer team and the Honors program discuss their individual experiences, how they stay balanced, the limitations and stigmas they face, and their reasons for being student-athletes in Honors.

### *Impact of Dream Boards on Long Term Goal Accomplishment*

#### **Sarah Katz - Wingate University**

This research aims to create a longitudinal study examining the effects of dream boards on goal identification and inspiration, conversion of these goals into actionable steps, and the impact of written versus unwritten goals across various ages.

## Studio E

### *Performance Anxiety and the Benefits of Proper Breathing for Singing*

#### **Kate Zecher - Bellarmine University**

Music Performance Anxiety (MPA) is an issue for many performers. By learning about the mechanics of breathing and the psychology of this anxiety disorder and other related disorders, one may better understand MPA and hopefully overcome its symptoms.

### *Folie à Deux, A Madness Shared: Inspiration and Adaptation in NBC's Hannibal*

#### **Hannah Broam - Columbia College**

NBC's television show Hannibal is a work of art created from other art, shaped not only by the original source material of the Hannibal Lecter books and movies, but also mythology, religion, philosophy, history, music, art, and literature.

### *Is Psychostimulant Effective in Enhancing Cognition?*

#### **Cali Clark, Alexandria B. Cantrell, Dr. Ilsun White - Morehead State University**

Recent reports indicate that there is a sharp increase in use of psychostimulants among healthy individuals in order to enhance cognitive function. Currently, we are examining the effects of amphetamine on scopolamine-induced impairment.

## Studio F

### *Racial Profiling and the War on Terror*

#### **Stephanie Downing - Marymount University**

Racially profiling Muslim Americans following 9/11 has adversely impacted national security and society. It is essential for U.S. officials to reflect on the historical lessons of race-based profiling and its ineffectiveness in combating terrorism.

### *Contested Memories Regarding Race and Religion- Christianity: The White Man's Religion?*

#### **Melisande Corlett - Norfolk State University**

During slavery Christianity was embraced by whites and they used Scriptures to justify slavery and their inhumane treatment of slaves. For this reason, blacks began to challenge Christianity and refused to support a seemingly corrupt institution.



*Labor, Race, and Solidarity in Yaa Gyasi's Homegoing*

**Elliott Geary - University of Tennessee at Chattanooga**

Yaa Gyasi's 2016 novel *Homegoing* follows several generations of a family separated by slavery and contains the story of a man named "H" that illustrates both the contributions and limitations of labor in building interracial solidarity.

## **Salon 5**

*Electoral Failure: An Analysis of the Flaws in the United States Electoral College*

**Joseph Moore - Eastern Kentucky University**

This presentation will address the problems inherent with the Electoral College system used to elect the president of the United States of America, and will look at possible solutions to these problems.

*Shifting Identity of Democracy in the Context of Classical Theory*

**Emily Cornwell - Murray State University**

There is reason to believe the original defining characteristics of United States' democracy are in decline. Reviewing policies of recent decades in the context of classical sociological theory can help explain this decline.

*De Rerum Natura: What Human Nature Dictates About Government*

**Holly Vlach - Samford University**

A paper examining the question of how human nature dictates forms of government.

## **Salon 6**

*Application of Tungsten (W) Attenuators for the Reduction of Downscatter Photons in Dual-Isotope Simultaneous-Acquisition Nuclear Cardiology Imaging*

**Steven Garner - Augusta University**

The photons from isotopes can be used concurrently to detect diseases. However, an issue in the Pb collimator makes these protocols difficult. Based on our results, W would be a suitable replacement for Pb as collimator for these protocols.

*Synthesis and Bioconjugation of Magnetic Nanoparticles to Induce Irreversible Damage to Glioblastoma Multiforme Invasive Rim Cells*

**Matthew Tovar - University of Mary Washington**

We describe the synthesis, analysis, and bioconjugation of superparamagnetic iron oxide nanoparticles (SPIONs). These SPIONs will be used to target and eliminate deadly glioblastoma cells.

*A Comparison of Copper Combined with a Polymer Matrix or Stainless Steel for Use as an Antimicrobial Surface in a Hospital Setting*

**Barika Mirza - Virginia Commonwealth University**

Via a meta-analysis on copper-bearing stainless steel and copper-embedded polymer matrices to deduce efficacy in reducing nosocomial infections, I found that while both show increased copper ion release, polymers are cheaper. More trials are needed.

## **Salon 7**

*How Depression Impacts Interpersonal Communication and the Ability to Develop Self-Leadership*

**Kathryn Trier - Columbia College**

Communication and self-leadership are essential parts of our daily lives, but depression breeds communicative dysfunction. This presentation aims to prove the intimate link between communication, depression, and self-leadership.

*Vulnerable Narcissism and First Person Singular Pronoun Use*

**Hannah Dorough - Georgia Southern University**

The main correlates of self-focused language (e.g., “I”, “me”) are depression and negative emotionality. I will propose a project that centers on these correlates, and a possible novel correlate: vulnerable narcissism.

*Linguistic Analysis of Written Language Used By Young Adults With and Without Invisible Disabilities*

**Amanda Schwartz, Dr. Amye Warren - University of Tennessee at Chattanooga**

The present study explores written language patterns of individuals with and without invisible disability using Linguistic Inquiry and Word Count analysis. Participants include young adults with a diagnosis of ASD, depression, or no diagnosis.

## **Session E - 9:15AM to 10:15AM**

### **Studio A**

**RESEARCH PANEL: Gender Diversity in Honors Recruitment and Retention**

**Matthew Reed, Patrice Splan, Nina Schenk, Cynthia Zastudil, Lauren Palmieri, Matthew Best, Philip Frana, Jared Diener - James Madison University**

Do we have an obligation to close the gender gap in Honors? JMU TAs and Madison Honors Council members explore the need for diversity recruitment and retention by assessing relevant research, recruiting and admissions practices, and program culture.

### **Studio B**

*Teaching in Threes: Possibilities & Pitfalls of Team-Teaching an Interdisciplinary Foundation Course with Three Faculty*

**Nathan Hedman - High Point University**

This short talk will present and analyze a faculty Teams-of-Three approach in teaching the Humanities Foundation course at High Point University. We'll discuss this new model of interdisciplinary instruction, its pitfalls and best practices.

*Include>Conform: Strategies For Teaching Diverse Students*

**Emily Robertson - Jacksonville State University**

Classroom teachers have the responsibility to overcome their personal biases in order to create an atmosphere that is celebratory of all diversities. They must decide which will be accepted in their classroom: inclusion or conformity?

*Impact of Note-Taking Style on Academic Performance*

**Abigail Valenta - Wingate University**

The current study further evaluated the impact of handwritten versus typed note-taking strategies on a post-lecture quiz. Results showed differences based note-taking strategy. Implications for teaching practice are discussed.

### **Studio C**

**RESEARCH PANEL: Macro- and Micro-Economic Issues in Global Business**

**Megan Nguyen, Katherine Trang - Columbia College; Emmanuel Obodochine - Georgia Southern University; Olivia Jennings - Eastern Kentucky University**

This research panel from three institutions discusses macro- and micro-economic issues within global business: unemployment in Nigeria, global cryptocurrency, and Big Data in marketing campaigns.

## Studio D

*The Importance of Public Sector Auditing to Government Accountability and Democracy: Auditing the Department of Defense*  
**Mirella Dankova - Birmingham-Southern College**

Until recently, the Department of Defense had the dubious honor of being the only U.S. government agency to have never been audited. Public sector auditing is essential in a democracy, hence the importance of the Pentagon's first audit.

*GAAP vs. IFRS*

**Julia McCormick - Jacksonville State University**

The US always seems to be different than the rest of the world. It even uses a different set of accounting standards. Although GAAP and IFRS have many similarities and are working to converge, many differences still exist.

*Cross-Cultural Examination of Employer Support in Business*

**Shawn Tuman, Haley Lipton - James Madison University**

Our project presents a cross-cultural examination of the effect of employer support on employee productivity by analyzing the findings of existing research in the U.S and Europe. In today's world, is pursuing the person a better path to proficiency?

## Studio E

*Attachment and Insanity in Pink Floyd's The Wall*

**Margaret Geddy - Georgia Southern University**

Analyzing Pink Floyd's The Wall as a narrative sequence of poetry, this paper explores how early childhood relationships with mothers and other primary caregivers affects the psychological, social, and emotional development of an individual.

*I Can Remember Everything: An Examination of Children's Metacognitive Abilities and the Testing Effect*

**Fulk Caitlin, Dr. Stacy Lipowski - High Point University**

Success in school is determined by students' ability to accurately monitor learning. Children learned lists of items through test and restudy. The goal was to determine whether testing improves memory and metacognitive monitoring in preschoolers.

*Why Teach?*

**Dahriel Barber - Miles College**

This research paper will answer the question: "Why Teach?". I am an Education major and I get asked this question a lot. Furthermore, I decided to research the topic because many people have made comments to me like, "Why do you want to teach? Teachers do not make that much money. "Therefore, I will be fiving insight on the extrinsic and intrinsic rewards of being a teacher. Teachers may not make the most money but the benefits that come along with teaching can be very fulfilling. This paper argues that teaching is one of the best careers in our world today.

## Studio F

*The Impact of Social Influences on the Perceived Likelihood of Academic Dishonesty Among Undergraduate Business Students*

**Joseph Harrison - East Carolina University**

This study uses Latané's (1981) social impact theory to explore the impacts of social influences, as they pertain to an instructor in a classroom setting, on the perceived likelihood of academically dishonest practices.

*A Twisted Tangled Tangent of a Situation: The Theoretical causes of rape and their effect on Legislation*

**Nicole Morris - University of West Georgia**

In this presentation the theoretical causes of rape and their involvement in the creation of legislation are evaluated, finding that there are solutions to the problem of rape, but that they exist within a cultural context versus a legal context.

*Locked Up, Then Locked Out: Factors of the World's Largest Prison Population*

**Savannah Payne - University of West Georgia**

Currently there are more than 2.3 million individuals in American prisons. What factors explain this increase of incarcerated individuals? This is an important question because incarceration impacts millions more than those behind bars.

## Salon 5

*Paranoia of Paternity, Emphasis on Femininity, and Importance of Women's Reproduction*

**Brady Gwynn - Georgia Southern University**

Many of Shakespeare's plays lack a mother character. However, this absence does not limit the allusions towards the idea of motherhood. This paper explores how stereotypes surrounding cuckoldry and femininity fuel the depiction of mothers.

*No Más Femicidios: Ni Una Menos & Other Feminist Movements Across the Spanish World*

**Madelyn Harvin, Taylor Close - Georgia Southern University**

#NiUnaMenos is a movement that protests femicide in Latin America. Our presentation will evaluate how the movement started and how it is currently spreading, as well as other movements that have resulted from similar circumstances in Spanish-speaking countries around the world.

*The Ancient Egyptian Woman Depicted: Survival vs. Class Structure*

**Arden Craft - University of Tennessee at Chattanooga**

Examining Menkaure and Khamererenebty (2490–2472 BC) and Bust of Nefertiti (1345 BC), clearly shows that Ancient Egyptians were as interested in understanding and analyzing the feminine physique as previous civilizations.

## Salon 6

*Women and Spirits in The Tale of Genji*

**Molly Phelps - Bellarmine University**

This project looks at the relationship between women and the supernatural in The Tale of Genji. The goal is to show how Lady Rokujo uses spiritual powers to rebel against the sexual hierarchy of Heian Japan while not fully defying its sexism.

*Examining Femininity Through the Homoromantic Poetry of "Matchless Orinda"*

**Autumn Grace Anderson - Murray State University**

Katherine Philips earns her title as "Matchless Orinda" for her beautifully complex love poems to her female friends. The planes of love examined within these 17th century poems are key to redefining femininity and the societal expectations of women.

*In Her Place; Out of Mind*

**Fiorella Rodriguez Moscoso - Wingate University**

In "The Yellow Wallpaper," the chronicled feminine suppression demonstrates what happens when female agency is ignored for male conceit.

## Salon 7

*Creating an Honors Badging Program*

**Quakish Liner, Ana Cowo - Broward College**

Broward College's Honors College has been successful in creating a multi-layered badging program for new faculty members that are interested in teaching honors.

*Resisting Neoliberalism in Honors Education*

**William Carpenter - High Point University**

Honors curricula should help students interrogate neoliberal trends in higher education.

*Integrating Traditional Advising Skills to Honors Advising: What should Stay and What should Go*

**Kara Horwood - Hillsborough Community College**

Moving from General advising to Honors and merging knowledge from one to another has been an interesting transition.

There are skills useful in traditional advising that can be added into Honors, but there are also skills that need to be unlearned.

## **Session F - 10:30AM to 11:30AM**

### **Studio A**

**RESEARCH PANEL: *Using Online Threaded Discussion to Promote Reflective Learning in Honors Courses***

**John Zubizarreta, Hannah Broam, Alexa Karoly, Abigail Tempel, Kathryn Trier - Columbia College**

Online threaded discussions are a powerful tool for enhancing students' critical thinking and writing skills while developing habits of critical reflection, collaboration, and self-directed learning in honors courses.

### **Studio B**

*Crossing the Line: Libya's current slave trade*

**Victoria Ilesanmi - Hillsborough Community College**

A viral video from Libya shocked the world, showing migrants being auctioned for approximately 400 US dollars. Libya has crossed the line between voluntary employment and enslavement. The divergence between Libya's past and present will be explored.

*Human Trafficking: How Outside Influences Increase the Crisis*

**Leah Rullman - Murray State University**

This presentation will explore how domestic human trafficking policies, United Nations intervention, and legalized prostitution impact rates of trafficking, by looking at the cases of the United States, Haiti, and the Netherlands.

### **Studio C**

*Higher Education and Politics in the United States and the United Kingdom*

**Anna Kwiatkowski - Georgia Southern University**

To what extent has higher education in the United Kingdom surpassed higher education in the United States over the past four decades and how has this occurred?

*The Remnants of Education within a Technological Society*

**Abigail Meert - Georgia Southern University Armstrong Campus**

An in-depth analysis of the meaning of a liberal arts education and its relationship to the overarching university system, as well its place within a modern, continually expanding technological society.

*Flipping MATH 114*

**Jenna Foster - Radford University**

The purpose of this study was to examine the effects of flipping a general education math course. This study examined students' achievement on the unit test, their perspectives of learning, and lessons learned from the flipped learning experience.

## Studio D

*The Manners Housing Foundation Inc.: Housing Homeless St. Petersburg College Students*

**Lisa Manners - St. Petersburg College**

The presentation will focus on how many students are homeless at SPC, how they get to class, where they shower, and how The Manners Housing Foundation Inc. has a plan to help these students succeed.

*The Making of a Ghost Town: The Environmental Disaster in Picher, OK and Today's EPA*

**Amir Ahmed, Kane Agan, Amanda Bialicki, Fernando Colunga, Leahgrace Simons - University of Alabama at Birmingham**

This presentation explores how Picher, Oklahoma's vast, underground, lead reserves birthed a mining boomtown that would later become one of America's most toxic ghost towns and how the EPA is rapidly becoming a ghost town of its own.

*Feeding Habits of Costa Rican Neotropical Butterflies*

**Samantha Franklin, Katie Ethridge, Kayla Grimes - University of North Georgia**

Over five days in Monteverde Costa Rica, my team, including local butterfly expert Jose Montero, tracked the feeding habits of Neotropical butterflies in order to better understand how to capture and track them for conservation purposes.

## Studio E

*The Applications of Drones*

**Sumayyah Ishaq - Northern Virginia Community College**

Drones are a technology with a large and growing number of applications. These fields range from agriculture, film production, and law enforcement to search and rescue. This presentation will explore the new and unexpected applications of drones.

*Densely Connected Convolutional Neural Network for Natural Language Processing*

**Yannik Glaser - University of North Georgia**

Evaluation of modified densely connected convolutional neural networks for text classification in comparison to other state-of-the-art algorithms. Results indicate performance gains on large datasets.

*Pneumatic Conveying Test Loop Design for Industrial Systems*

**Natalie Burdine - University of Tennessee at Chattanooga**

In designing pneumatic conveying systems, laboratory testing to determine design criteria is superior to a theoretical approach. This project proposes a system that collects data regarding conveyed materials.

## Studio F

*Investigating Lexical Exchange between Basque and Castilian, from the Reconquista to Modernity*

**Gabriel Foral - Augusta University**

Research concerning the relationship between Basque and Castilian, using methods of historical linguistic analysis to investigate the relationship and co-development of Basque and Castilian, both the languages and the cultures.

*Story telling and memory as it relates to the Spanish Civil War, Franco's Regime, and 21st Century Spain*

**Syreen Goulmamine - Randolph-Macon College**

Through extensive analysis of Javier Cercas' novel, *Soldiers of Salamis*, we explore the relationship between memory and storytelling in the context of the Spanish Civil War, Francisco Franco's regime, and Spain in the 21st century.

*Russian Nationalism and Spanish and Russian Literature in the Spanish Civil War*

**Emily McAndrew - University of Tennessee at Chattanooga**

Russian socialists deeply affected 1920's Spanish nationalism; this project explores transcontinental Spanish and Russian literature and their link to the development of the Nationalist political and social movement during the Spanish Civil War.

## Salon 5

*Postmortem protein degradation as a tool for estimating time of death in forensic cases*

**Allison Lindsey - Pfeiffer University**

To relate protein degradation with time of death, we optimized procedures to use Desmin extracted from chicken and pig in a series of experiments to map its degradation using SDS-Page, Western Blot analysis, and Coomassie Stain.

*The Commercialization and Commoditization of Celebrity*

**Maggie Payne - Lynchburg College**

This case study analysis will extend marketing theories and ultimately the four P's and four C's of marketing to address how celebrities market their brand in order to reach the consumer.

*Dysgraphia: Symptoms, Diagnosis, and Treatment*

**Danielle Saylor - Southeast Kentucky Community and Technical College**

This presentation will cover the process of recognizing symptoms, seeking diagnosis, and possible treatment options because, if more people become aware of these symptoms more people with dysgraphia will be able to live up to their full potential.

## Salon 6

*The Pain of Countries*

**Emma Warax - Milligan College**

My research seeks to explain how Venezuela experiences the five stages of grief during the present economic crisis that began in 2012.

*The Role of Jerusalem: What Does Trump's Blunder Mean for the Israel-Palestine Conflict?*

**Ala'a Abu-Spetani - University of Alabama at Birmingham**

The Israel-Palestine conflict continues due to the failure of solving key issues like Jerusalem. With Trump's declaration that Jerusalem is Israel's capital, it is important to evaluate Jerusalem's role to determine if there is still hope for peace.

*Taiwan's Growing National Identity and Cross Strait Security*

**Henry Crawford - University of North Georgia**

The status quo between Taiwan and the PRC is vital to American security interests in Asia, but the growing influence of the Taiwanese independence movement has changed the nature of this territorial struggle.

## Salon 7

*The Impact of Body Cameras on Public Perception of Police Use of Force Situations*

**Joseph Hamilton, Lambert Gary - Randolph-Macon College**

This study examined public perceptions of police use of force using video footage of a simulated police shooting. These results highlight one of the primary factors in the growing divide between police officers and the communities they serve.

*The Art of Compromise: Police Discretion as a De-escalation Tactic*

**Madison March - University of Alabama at Birmingham**

Police officers have the ability to reduce use of force incidents and de-escalate situations through their power of discretion. Use of discretion by police can improve police-community relations and reduce the crime rate.

*Cybersecurity, Hacking, and E-Voting*

**Connor Correll - Wingate University**

This project examines the assumed Russian meddling in the 2016 U.S. Presidential Election by analyzing findings from the intelligence community. This meddling is part of a larger disinformation campaign to undermine the U.S. democratic process.

## **LUNCH AND BUSINESS MEETING**

**11:45AM to 1:15 PM in Salon 1-4**

### **Session G - 1:30PM to 2:30PM**

#### **Studio A**

*RESEARCH PANEL: Risky Business: Suppression of Speech in Academia*

**Rachel Hofer, Aaron Crawford, Ashley DeGennaro, Natalie Hurst, Dameshia Seay**

The UTC Honors Seminar "Scholars and Journalists at Risk" explored the issues of freedom of speech and partnered with the nonprofit Scholars at Risk to advocate for two wrongfully imprisoned Iranian scholars

#### **Studio B**

*Mythicized Place in the #NoDAPL Movement*

**Evangeline Giaconia - Appalachian State University**

The 2016 NoDAPL movement was characterized by several place myths that bolstered international support. These narratives served as examples of the critical process of uplifting decolonized indigenous stories as we work towards a cooperative future.

*Beetles of Rowan County: a survey of various collecting and preservation techniques for beetles surrounding the Daniel Boone National Forest*

**Kathryn Branham - Morehead State University**

To explore the biodiversity of the region surrounding the Daniel Boone National Forest, various trapping methods were utilized. Beetles were captured, processed, and finally categorized by family to discern different niches among various organisms.

#### **Studio C**

*ADMINISTRATIVE ROUND TABLE: Enticing Transfer Students: What Are We Doing Right? What Are We Doing Wrong?*

**Patrick Bahls - University of North Carolina, Asheville; Kirsten Bartels - Northwestern State University Louisiana Scholars' College**

We examine findings from an ongoing study of honors policies, procedures, and promotional materials, noting obstacles to transfer students' success in honors. We will also discuss means of making honors more accessible to such students.

#### **Studio D**

*The U.S. Experience Economy: Understanding Our World*

**Tori Jackson - Pfeiffer University**



The Experience Economy, a term coined by Pine and Gilmore, provides insight into the new era of the American Economy. Looking at past trends and current consumer demands, experiences could potentially become the primary driver of the future economy

*Straight Outta Compton, Straight from the Ghetto?: The Dangers of Stereotypes through Hip-Hop*

**Bodie Fox - Georgia Southern University**

This presentation examines stereotypes surrounding Hip-Hop to display their danger, while making the audience aware of these stereotypes.

*Is Your Phone Smarter Than You? Smartphone Usage and Academic Performance*

**Kortni Beeson - Radford University**

The current study examined the relationship between smartphone use and academic performance. The degree to which students text as opposed to emailing or calling others is inversely related to academic performance - particularly for social contacts.

## Studio E

*Analysis and Comparison of the United States Political Party Systems and Election Laws to that of a Western European Counterpart*

**Jneva Norfleet - Virginia State University**

I will first examine the political and administrative factors placed on governmental elections. Secondly, I will inform the audience of the United States local, state, and national political procedures compared to a Western European country.

*The Rise of Contemporary Populism and Its Relationship to Post-Truth*

**Sunya Reddy - University of Alabama at Birmingham**

The presentation explores contemporary populism and post-truth in order to determine a relationship between the movements; it discusses the ramifications of an interaction between these movements, as well as ways to combat such detrimental outcomes.

*Democracy in Nepal*

**Emily Rothstein - University of Mary Washington**

I am studying the process through which a state becomes a democracy using Nepal as a case study, and specifically how the Maoist insurgency influenced the adoption of the 2015 constitution and the resulting federal system.

## Studio F

*Women's Role in the French and Russian Revolutions*

**Savannah Tranter - Greenville Technical College**

As the people of the French and Russian Revolutions fought to overthrow their weak governments, revolutionary women fought within these movements for equal rights and representation.

*The Legacy of Josephine Baker: Performer and Activist*

**Fiona Scruggs - Radford University**

Josephine Baker's extraordinary life and career influenced the performing arts, films, World War II, and the Civil Rights Movement. From children's author to espionage, she was a revolutionary, daring legend of the stage, screen, and social equality.

*The Korean Wave: K-Drama and Modern Perceptions of Gender and Relationship of Young Vietnamese Women*

**Thu Nguyen - Wesleyan College**

The study identifies potential correlations between Korean Drama and its Vietnamese audience's modern perceptions of gender & relationship and calls for guidance and mentorship for young women in this important time of change.

## Salon 5

*Combined Caloric Restriction and Reduced Estrogen Affect Bone Density Ramon*

**Ramon Mislá David - Liberty University**

Bone loss may be greater under combined CR and estrogen loss. While OVX resulted in less vertebral BMD, in combination with CR no further bone loss occurred. Data suggests CR protects against OVX-induced bone loss; rather than causing more bone loss.

*Putting your own Oxygen Mask on First: Examining Stress Levels, Management Techniques, and Attitudes among College Health Students*

**Charlotte Hepler - Marymount University**

Health professionals ensure the well-being of our population, yet many struggle to maintain their own self-care. Poorly managed stress directly contributes to worse outcomes for patients. By fostering stress coping techniques burnout may be lessened.

*Opternative: Health and Economic Drawbacks*

**Annie Hulsey - University of Tennessee at Chattanooga**

Telemedicine website Opternative provides low cost vision exams from home but lacks a comprehensive eye health exam. The risks Opternative poses to people's eye health and the economy of optometry will be assessed using surveys and research.

## Salon 6

*Of Mice and Social Mentalities*

**Kallie Brown - Birmingham-Southern College**

This project works to show that anachorism, a term created by social geographer Tim Cresswell that means being out of place, can be exemplified in the novel *Of Mice and Men*.

*Out of Sight Out of Mind: An Analysis of Social Isolation in Nineteenth Century Literature*

**Chelsea Hatfield - Catawba College**

Charlotte Brontë and Charlotte Perkins Gilman, two prominent writers of the nineteenth century, may not have many similarities at first glance. Yet when you begin to analyze social isolation within their texts, there is more than meets the eye.

*The Tide: A Short Story*

**Emily Garrett - Murray State University**

She seemed to complete the masterpiece that portrayed their current scene so vividly. The crackling bits of shell beneath their feet, the salinity of the wind, the rushing waves that pounded the shore and sloshed up against their ankles...

## Salon 7

*On the Edge of Disaster: History, Culture, Fantasy, and Geology*

**David Kime, Kira Turner - Northern Kentucky University**

This session describes a seminar linking the science of natural disasters to their cultural impact. Presenters will discuss the use of case studies, cultural artifacts, and a fictional thought experiment to connect seemingly disparate disciplines.

*Est. 1873: An Illustrated History of Martin, Tenn.*

**Rachel Melton - University of Tennessee at Martin**

The project highlights historical information central to Martin, TN and renews it in a contemporary design style through a research based process. It is the hope of the artist to build an appreciation for design as a way to preserve local history.

*“You’re better than this. You can be better than this”*: Re-Considering Igor and the Power of Human Potential in McGuigan’s Victor Frankenstein

**Keri Jones - University of West Georgia**

By examining Paul McGuigan’s version of the hunchback lab assistant, Igor, and his relationship with Frankenstein in his film, Victor Frankenstein (2015), we receive a lesson in human connection and potential that Mary Shelley’s characters lacked.

## Potomac 1

### **HONORS BEST PRACTICES**

*Honors in Action*

**Kim Duong, Rachel Emond, Alexa Karoly, Phoebe Le, Kristen Soucy, Deonna Starks - Columbia College**

Honors students take on valuable internship experiences to engage in learning beyond the realms of a classroom. Students will share opportunities and challenges when stepping into a professional working environment and how they embrace it.

*Breaking the Publishing Glass Ceiling: An NCHC Honors Undergraduate Research Journal*

**Zeke Starr, William Garrett - University of Tennessee at Chattanooga**

URECA, NCHC’s web-based undergraduate research journal, is double-blind reviewed and student-operated. This panel explores the potential for experiential learning opportunities provided by developing and promoting a national journal.

*Student Engagement in Honors: The Ups and Downs of Honors-specific Extracurriculars*

**Jordan Reich, Caleb Howell, Logan Turner - Northwestern State University**

Student representatives from the Louisiana Scholars' College will share their experiences with the student-led honors governing body and improving student engagement through special events, social activities, and mentoring.

## Session H - 2:45PM to 3:45PM

### Studio A

**RESEARCH PANEL: Fascism Today - A study of Nazi Germany and how its Fascist characteristics appear in our world today**

**Laine Parker, Jessica Ferguson, Hannah Roberts - Gardner-Webb University**

Fascism is best known for influencing Nazi Germany. But what is fascism? Is our world becoming more fascistic? GWU students tackled these questions in a seminar studying components of fascism. Fascism may be more prevalent today than one might think.

### Studio B

*Chelation of Metal Ions by the Siderophore Vicibactin*

**Joshua Stinnett, Dr. Ranjan Chakraborty - East Tennessee State University**

Siderophores are iron chelating molecules made by bacteria in iron deficient environments. Vicibactin is a siderophore produced by *Rhizobium leguminosarum* to sequester iron. Experiments show whether it can also sequester other metal ions.

*Characterization of Magnetic Thin Films using the Magneto Optic Kerr Effect*

**Nicholas Savino - Lynchburg College**

The Magneto Optic Kerr Effect (MOKE) displays the reflective response a magnetic material has to a magnetic field. Magnetic thin films were examined for their magnetic properties using a home-built MOKE system.

*The Response of Fuzzy Electronics to Ionizing Radiation*

**Simar Singh - University of Tennessee at Chattanooga**

This study compares two types of attitude control systems, a fuzzy control system and a PID control system, to determine which of the two is more robust in extreme environments.

## Studio C

**ADMINISTRATIVE ROUND TABLE: Facing their Demons -- Internet Addiction and Honors**

**Kirsten Bartels - Northwestern State University Louisiana Scholars' College; Patrick Bahls - University of North Carolina, Asheville**

From the siren call of the virtual world, to displacement of self; from loss of sleep, to the spiral of missing classes and falling grades; from the toy to the drug; this panel discusses the growing issue of internet addiction in Honors.

## Studio D

*Where Literature and Philosophy Meet and Diverge*

**Clare Hagan - Bellarmine University "**

This essay examines the intersection of literature and philosophy, using Kant's Critique of Judgment as a way into analyzing Plato's Phaedo, as an example of literary philosophy; and Shakespeare's Hamlet, as an example of philosophical literature.

*The Light at the End*

**Ty Gibbs - Southeast Kentucky Community and Technical College**

Using comprehensive and interdisciplinary context, this presentation will discuss death, the idea of an afterlife, and the different religious beliefs that surround the dying process.

*Socioeconomic Effects of the Black Death in Medieval England*

**Meghan Garity - University of North Georgia**

In England, the fourteenth century Black Death facilitated the emergence of a new economic system and perception of social status.

## Studio E

*Reconciliation in Letters from a Railway Man and the Power of Letter-writing in the 21st Century*

**Stella Childress - Murray State University**

Eric Lomax, a former POW during WWII, reconciles with his torturer through letters. Communication theory and letter-writing research is applied to this case study, showing letters as a still valid form of communication in the 21st century.

*The Turing-Welchman Bombe: The Key for the Downfall of the Third Reich*

**Rebecca Journigan - Radford University**

Alan Turing and the other codebreakers at Bletchley Park employed an electromechanical device known as the bombe to read German encrypted messages during WWII. This talk will describe the logic behind how the bombe exploited the German Enigma cipher.

## Studio F

*Peer Mentors: Who is Mentoring Whom?*

**Belle Zembrodt, Josh Hamilton, Sydney Reinert - Northern Kentucky University**

Students will share the design of a peer mentoring course in which they learned the skills and knowledge to mentor incoming freshmen. They will discuss the benefits of the peer mentoring program to the freshmen as well as to themselves.

*One Foot In The Door: The importance of first year leadership and its impact within an honors council structure*

**Logan Mullins, Jade Jacobs - University of West Florida**

This presentation will be looking at first-year leadership roles. We will be explaining their function and importance as well as how they can transition into future leadership roles.

*The Strength Within Elizabeth Schuyler Hamilton*

**Sarah King - Southeast Kentucky Community and Technical College**

Elizabeth Schuyler Hamilton spent a significant amount of time taking care of her children and her husband Alexander Hamilton. However, she was much more than that. She contributed so much to the young United States and deserves to be recognized.

## **Salon 5**

*Sleep Disorders in Children Causing ADHD? Treatment with CPAP Vs. Medications*

**Lisa Manners - St. Petersburg College**

This presentation is an informative discussion on treating children for a sleep disorder vs. treating with medications right away, for ADHD symptoms.

*Review of Spanish Legislation and Transposition of European Union Directives Regarding Maternity, Paternity, and Parental Leave*

**Rachel Emond - University of Tennessee at Chattanooga**

This paper identifies how Spanish legislators have transposed EU directives regarding work-life reconciliation into Spanish law. The research concludes with a discussion of criticisms of these transpositions and factors affecting implementation.

*Variations in Mandatory Reporting Laws and Their Influence on Child Abuse and Neglect Reports and Rates*

**Kate Mobley - University of Tennessee at Chattanooga**

States were ordered based on the severity of their mandatory reporting and child welfare laws. Data on the rate of child maltreatment reports and cases was collected and statistical analyses were used to find relationships between the variables.

## **Salon 6**

*Using Pop Culture to Educate Students About Autism to Promote Inclusion*

**Savannah Hughes - Catawba College**

Use of different aspects of popular culture, such as film and novels, students can be better educated about autism. This education can promote empathy to make inclusion in public school more comfortable for all of those involved.

*The Price Inflation of Single-Dose, Life-Saving Drugs*

**Lauren Solomon - University of Tennessee at Chattanooga**

The purpose of this research is to determine if the price inflation of some life saving drugs is ethical according to Thomas T. Nagel's Ethical Pricing Test from *The Strategy and Tactics of Pricing*.

*Voluntary Active Euthanasia for Non-Terminal Illnesses: Is It Ethical?*

**Mary King - Lynchburg College**

This presentation will identify the factors that contribute to voluntary active euthanasia being morally permissible for patients of potentially treatable illnesses, primarily focusing on alcoholism in a case study from the Netherlands.

## Salon 7

*Sprawl: Unhealthy Road Systems and a Growing Kentucky Town*

**Spencer Stelzer-Weise - Eastern Kentucky University**

Richmond, Kentucky is a growing town, but has a road system that many believe to be problematic. Using Geographic Information Systems (GIS), I look at how Richmond sizes up and compare it to other communities in the region.

*Factors that Determine Success among Franchises: Theory and Empirical Model*

**Taylor Tidman - High Point University**

In multiple cases when potential franchisees decide to invest their life savings by acquiring a franchise, they do not know the problems they will face in near future. This study examines principal factors that contribute success among franchises.

*Exploring Perceptions of the Economy in the United States;*

**Corin Manning - Jacksonville State University/Alabama**

The objective of this project was to analyze the viewpoints of several United States' citizens about the future of the American economy.

## Potomac 1

*World Building in Comic Books: Comparing New X-Men and Rising Stars*

**Kala Byrd - Catawba College**

In comparing two different comic book series concerning the same overarching theme of differences in society, this project will highlight the approaches each author takes in character and world building in a story.

*Dragons and Desolation: Beowulf and J.R.R. Tolkien*

**Margaret Smith - Catawba College**

Just how big of an influence did Anglo-Saxon culture have on the father of modern fantasy? Quite a sizable one. This presentation will explore the concepts of the mead hall, the Anglo-Saxon hero, and more as they relate to Beowulf and Baggins alike.

*From Arthurian Legend to Comic Book Lore: The Dark Knight as an Idyllic Leader in Society*

**Jonathan Rife - Catawba College**

While Alfred, Lord Tennyson and Christopher Nolan may seem unrelated, this presentation analyzes Idylls of the King and The Dark Knight Trilogy to demonstrate the need for heroes in society by focusing on their characters, King Arthur and Batman.

## Session I - 4:00PM to 5:00PM

### Studio A

**RESEARCH PANEL:** *Avoiding War with North Korea / Evaluating the Effects of an Exercise Engagement Program on the Physical, Social, and Psychological Health of Combat Wounded Veterans*

**Logan Johnston - University of West Georgia; Joseph Hamilton - Randolph-Macon College**

Part 1 - How should the US respond to the threat posed by North Korea to national and international security? Without resorting to war, this paper explores our options in resolving our conflict with North Korea.

Part 2 - This study examined the effects of an exercise promotion program on the psychological health of combat-wounded veterans. Our findings suggest that exercise engagement programs may be an effective way to increase veteran's mental health.

## Studio B

*Indigenous Tribes in the Brazilian Amazon: Finding a Balance between Sustainability and Economic Development*

**Bernadette O'Donnell - Georgia Southern University**

The purpose of this research is to ascertain the best policies that will sustain isolated indigenous tribes in the Brazilian Amazon in the light of the government's interest to promote the country's economic development.

*Environmental Injustice: A Public Health Issue in Chattanooga*

**Dameshia Seay - University of Tennessee at Chattanooga**

The issue of environmental injustice is a problem in the Chattanooga community due to lead-contaminated soil. Affected residents have yet to see real efforts made to resolve the issue; I examine stigmas and possible solutions to this problem.

*Creating the Beach: The Early Development of Santa Rosa Island*

**Benjamin Kinnard - University of West Florida**

The status of Santa Rosa Island, a barrier island on the Florida Panhandle, has been hotly debated. This project examines the early development of the island from 1947 to 1954, which brings context to why these decisions drive today's debates.

## Studio C

*Kugelman Honors Program: O.W.L. Program and Admissions Process Review*

**Elizabeth Barrett - University of West Florida**

A student On-Campus Welcome Leader compares the admissions processes of honors programs throughout the Southeastern U.S. and re-examines of the role of student recruiters within the Kugelman Honors Program's changing admissions process.

*Putting "Community" in an Honors Living Learning Community*

**Philip Billings - University of West Florida**

Community is an essential part of any LLC, particularly in the high-stress environment of an Honors LLC. This presentation will cover methods which can be used to build upon a traditional programming model to foster a harmonious community.

*Engaging the Challenge of Growing the Diversity of Honors Communities*

**Courtney Swain, Bayla Bessemer - University of West Florida**

The challenge of diversifying honors programs and colleges will be addressed. A review of ways students and administrators can confront this obstacle will be surveyed and past successful cases in increasing diversity will be acknowledged.

## Studio D

*"May the hour of retribution and vengeance be near at hand for the traitor": The Story of John L Haynes, Texas Unionist*

**Matthew Kondrat - Bellarmine University**

John L. Haynes was a Texas Unionist who, as a member of the Texas House of Representatives, and through his leadership of the 2nd Texas Regiment of Cavalry in the Civil War, fought for the rights of Spanish-speaking Texans and against secession.

*The Civil Rights Movement: How Behavior Modification Changed the Future*

**Savannah Hughes - Catawba College**

Major events of the Civil Rights Movement are analyzed to determine which behavior modification techniques were successful in bringing about meaningful social change, or inhibiting it.

*On the Edge of Conflict: An Excursion to the Grand Canyon Exposes the Cultural Disputes over "Land Ownership" in the American Southwest*

**Stuart Jones - Eastern Kentucky University**

An NCHC Partners in the Parks trip to the Grand Canyon exposed students to the geographic and cultural struggles of the American Southwest. This presentation defines the issues pertinent to the region, as well as their relevance to the trip.

## Studio F

*The Heart of the Loire: The French Monarchy's Portrayal of Absolutism in their Royal Chateaux*

**Austin Collins - Catawba College**

The French Monarchy during the Renaissance elevated their absolutist regime through events such as the Wars of Religion. Their meteoric rise in power can be analyzed through their chateaux, royal ceremonies and artwork.

*The Principles of Public Terror*

**Jackson Tumlin - Greenville Technical College**

An examination of Maximilien Robespierre's inner motives and external leadership gives a richer understanding of not only Robespierre's figurehead status, but the successes and failures of the French Revolution itself.

*Darkness to Light: The Highest Level of Understanding*

**Deonna Starks - University of Tennessee at Chattanooga**

Both Plato's Allegory of the Cave and Excellent Sheep by William Deresiewicz discuss the value of understanding and questioning society. In this essay, I discuss the correlation between these two texts and people today and college students.

## Salon 5

*Employing H.264 Medium Grain Scalable Video to Optimize Video Playback over Passive Optical Networks*

**David Moore - Georgia Southern University**

The H.264/AVC medium grain scalable (MGS) video standard is employed to optimize video playback on passive optical networks (PONs). Video playback is improved by dropping scalable video layers as network utilization increases.

*Video/Image Quality Enhancement Using High-Resolution Frame Equalization*

**Wesley O'Quinn - Georgia Southern University**

This research proposes an image referencing technique that can take a low quality image and recreate it such that the resolution and quality can be improved. This is accomplished by using a high quality reference image, in addition to a combination of filtering methods.

*Optimizing the Parabolic Solar Trough Efficiency*

**Adil Riahi - Valencia College**

The purpose of our study is to optimize the efficiency of the Parabolic Solar Trough by enhancing the geometrical characteristics and/or the thermal components of the Parabolic Solar Trough.

## Salon 6

*Honors in Action: Servicing Veterans in the Community*

**Justin Abraham, Mary Ann Ebiefung, Kalie Shaw - Chattanooga State Community College**

HIA: Servicing Veterans in the Community is a presentation focused on an educational forum hosted at Chattanooga State Community College. The presentation will cover the entire process with the hope other students will take this back to their colleges.

*Economics in the Unexpected*

**Laci Gurganus - Jacksonville State University**



Reviews of three insightful, economic-based books will reveal how basic economic concepts can redirect the course of a person's life and the ways individuals can use these ideas to their advantage.

*Consumer Relationship Marketing and Social Media*

**Jesse Print - Pfeiffer University**

The topic of consumer relationship marketing is explored, with heavy emphasis on social media marketing, its uses in social media, the effectiveness of using social media as a medium for CRM, and its ethical implications.

## **Salon 7**

*It Ain't Necessarily So: Social Controversy Surrounding Gershwin's All-Black Jazz Opera*

**Zoe Wirt - Birmingham-Southern College**

George Gershwin's opera, *Porgy and Bess*, attempted to represent the black folk character and a corresponding musical style, but in his research and presentation, Gershwin created much controversy about authenticity and the American folk identity.

*Drama Is Conflict: An Exploration of Theatre's Driving Force Through Anna Deavere Smith's Twilight: Los Angeles, 1992*

**Nunna Noe - Catawba College**

Comprised of verbatim interviews taken after the LA race riots of 1992, Anna Deavere Smith's *Twilight: Los Angeles, 1992*, delves deep into complex themes while employing an atypical conflict structure. This paper probes the effects of that structure.

*The Ideal Community Theater Musical*

**John-Alex Warner, Jessie Thoman - University of Tennessee at Martin**

*The Second Time Around* is a completely original musical written entirely by John Alexander Warner. The show is designed specifically to accommodate community theater limitations without sacrificing the artistic nature of the work.

## **Potomac 1**

*Statehood and Sovereignty: A Case Study of William Livingston the Statesman, Philosopher, and Revolutionary*

**Caleb Dagnall - Kean University**

This presentation uses William Livingston, first elected governor of New Jersey, to study early American political thought on the concepts of statehood and sovereignty and how they have developed over time.

*The New American Dream*

**Erika Neal - Virginia State University**

It must be understood that The American Dream was made for a specific group of people, which makes it unjust since its creation. Over time this country has evolved, but the image and lasting impression of the American Dream has not.

*Headstone Typology, Symbolism, and Archaeology*

**Lauren Silvers - University of North Georgia**

When I was a child, I remember going to cemeteries with my charcoal and sheets of paper to create rubbings of the interesting headstones. This inspired a fascination with symbolism and typology of headstones and how they may have changed over time.

## VCHC Flash Talks and Recognition Ceremony

5:00PM to 7:00PM in Salon 1-4

### *How to Make Good Decisions*

#### **Leilani Porter - James Madison University**

Decision making is a vital process. Before beginning to work on problems, we must identify exactly what the issue is to have focused collection. In the collection process, we investigate all relevant information. If the problem pertains to the problem, we include it in our collection strategy so that we can make the most informed decision possible. We weigh all evidence, looking especially for a variety of sources, and assess them as objectively as possible. We try to refrain from mirror imaging, which means, thinking that others would behave in a similar way. We pick the option that delivers political, social, or financial relief. We commit to our solution. If it fails, we ask “Why didn’t that work?” before making the next decision.

### *The Role of Government in Healthcare*

#### **Andrew Parr - James Madison University**

I will seek to answer the following: How does the current U.S healthcare system operate; how is the system flawed; what are the similarities between the U.S healthcare system and other systems abroad and how do these factors influence the efficiency of treatment, and lastly, what changes can be made to the U.S system if any to maximize efficiency and lower costs? In addition, in 1933 Sidore Falk and Edgar Sydenstricker were enlisted by President Franklin Roosevelt to draft the first social security plan for a public healthcare program. The ideas they created were condemned by the American Medical Association; thus, began the debate of the role of government in healthcare and the conflict between organized medicine and universal American healthcare. Because of this unique history of conflict in the United States I will seek answers to the question of the role of government in healthcare.

### *Learning Compassion through the Performing Arts*

#### **Sierra Orr - James Madison University**

I hope to study African American and Latin American identities. In particular, I am interested in how these identities are shaped by multiple and competing influences of such things as religion, race and ethnicity, language, and socioeconomic factors, or intersectionality. This is a concept that demands the understanding of several different aspects of identity, so I hope to focus on language, religion, and race and ethnicity. I propose to use my growing understanding of African American and Latin American identities to design music and theatre education programs to address concerns and needs of not only people claiming these identities, but the whole community. My hope is that I can learn how to create an inclusive classroom in which everyone feels known and represented on the stage. I also hope to study compassion and empathy and how one can learn and use the two through theatre education. This takes both in the traditional K-12 classroom as well as the community.

### *Education Accessibility and Advocacy*

#### **Elizabeth Elia - James Madison University**

Education is power. More than that, it is understanding. Increased education creates benefits for all aspects of society, but it also allows individuals to gain a greater understanding of the world and the people around them. In a divided society, education is key to creating empathy and the ability to compromise. By denying education access to individuals, we are excluding sections of society from the narrative, making them unwelcome in debate for lack of knowledge. They are unwillingly forced out of civic participation. This is why education accessibility is so important. I will explore the social inequalities, economic disparities, and governmental policies that influence education inequality, primarily on the national level. I will also explore the reasons why advocacy is so important as well as why it is the duty of individuals with access to high quality education to work to open these conversations to all members of our society.

### *Biomedical Illustration*

#### **Kristen Connors - James Madison University**

Through an interdisciplinary major in Biomedical Illustration, I aim to explore how visual communication enhances one's ability to conceptualize and represent human biology. Working at the intersection between health science studies, biology, and studio art, I will develop a technical skill set in illustration that allows me to represent the human biology so that it can be understood by others. During health science courses, I will identify barriers to public access to health and wellness knowledge. During biology courses, I will learn about the anatomy, physiology, genetic makeup and development of the human body, and identify under-researched concepts as well as concepts that are difficult for future health care professionals to grasp. I will then seek to use my artistic and creative skills to address these problems, and create illustrations which facilitate learning.

### *Birth Order Characteristics in Boone Honor Program*

#### **Hunter Miller - Ferrum College**

The premise of my presentation will be about how birth order theory applies to members of the Boone Honor Program and the results I gathered from my personal research. Dr. Kevin Leman's birth order theory as laid out in *The Birth Order Book: Why You Are the Way You Are* suggests that the majority of gifted students should be firstborns because firstborn children tend to be more scholarly than middle and lastborns, having strong work habits and a well-developed sense of responsibility. Research in genetics also suggests that firstborns get the best genes for intelligence in a family. In addition to this, Dr. Leman identifies numerous reasons why a last or middle born child may act as a functioning firstborn, and my research was aimed at trying to see if these theories hold true in Ferrum College's honors program. I sent out a survey to honors members with questions designed to elicit the age and gender of all siblings and parents (including the parents' own birth order position), and a few questions aimed at finding other possible variables to account for those who may not be a firstborn.

The presentation will have three parts. Part one will be a brief overview of Dr. Leman's birth order theory, focusing on its application to honors program members. Part two will be a summary of my research results. Part three will be analyzing the results, and discussing how this further reflects Dr. Leman's theories, including any departures from conventional thinking about birth order.

### *Edible Landscaping for the Students and Wildlife*

#### **Katherine Anderson - Ferrum College**

In my presentation I plan to discuss the process of getting edible berries planted on Ferrum College's campus and at the Titmus Agricultural Center, the college's farm. I will describe the difficult processes of writing a grant proposal, getting the project funded, and the amendment of the soil. After briefly describing my own experiences, I will bring the conversation to edible landscaping, and involve the audience with some questions, such as: do you have edible landscaping on your campus, that you know of? Do you know where the fruits and vegetables in your cafeterias come from? And most importantly, would you like to have edible landscaping on your campus? The presentation will end with a discussion on making changes on college campuses: how easy it can be, and how enjoyable it has been for me.

### *Investigation of fungal endophytes within American and Chinese chestnut tree seeds and seedling*

#### **Dillon Richardson - Shenandoah University**

The entire American chestnut tree population in the U.S. has been nearly destroyed due to the introduction of the invasive Asian fungus, *Cryphonectria parasitica* in the early 1900's. While there are multiple ongoing approaches to restore the American chestnut tree to our forests, we are interested in understanding the role the tree microbiomes, specifically fungal endophytes, play in warding off *C. parasitica* infections. Endophytes are microorganisms, mainly fungi

and bacteria, that live within, and benefit, plants. Previous studies have shown that some fungal endophytes can be passed from parent tree to seed. In this study, we investigate the fungal endophyte populations between American and Chinese chestnut trees within seeds and seedlings to better understand when and how these trees are populated by their microbiome. American and Chinese chestnut seeds were surface-sterilized, opened, and fragments were plated on nutrient-free agar. Fungal samples were isolated, maintained in pure culture, and identified by DNA sequencing. Similar procedures were used on 2-week old chestnut seedlings. Our investigation will help determine whether any endophytes are passed from American and Chinese chestnut parent trees to seeds and seedlings, providing valuable information about basic American chestnut biology and contributing to ongoing American chestnut restoration efforts. In the long term, we hope to determine whether endophyte diversity contributes to Chinese chestnut resistance to *C. parasitica*.

**FILM VIEWING – “The Linguists”**  
**9:00PM to 11:00PM in Studio B**

**Saturday, April 7<sup>th</sup>**

**Breakfast**

7:00AM to 9:00AM in Salon 1-4

**Session J - 8:00AM to 9:00AM**

**Studio A**

**RESEARCH PANEL:** *Through the Eyes of a Researcher and a Participant: How Two Individuals View the Hurricane Katrina Evacuation Differently Based on Perspective*

**Eli Hardin - Gardner-Webb University, Nicholas Brondum - Eastern Kentucky University**

These two students have a deep understanding of the problems associated with the evacuation ahead of Katrina, albeit from different perspectives. This panel allows us to best understand the event through a comparison of knowledge and experiences.

**Studio B**

**HONORS BEST PRACTICES:** *The Demographics of Honors Participation at Georgia College*

**Shelby Bennett, Steven Elliott-Gower - Georgia College**

This research project examines demographic data pertaining to curricular and extracurricular participation in the Georgia College Honors Program.

**Studio C**

*Subsidies in Higher Education Distort Price Signals in the Labor Market: A Model of College Major Selection*

**Samuel Barker - Pfeiffer University**

This research models how university students change their major choice in response to changes in governmental financial aid. It comes to the theoretical result that as subsidies increase students become less incentivized to choose high paying majors.

*Sustainability Attitudes of College Students as Future Business Leaders*

**Garrett Hinton, Dr. John Kirchoff - East Carolina University**

Sustainability is increasingly common at universities. Professors stress the importance of sustainable practices to their students, but do they comprehend? This research provides insight into student attitudes toward sustainability in the workplace.

*Pathway to Leadership*

**Max Peters, Hunter Draut, Alex Powers - Virginia Wesleyan University**

Osgood Center Leadership program exposes students to professional speakers who provide a wide range of interdisciplinary perspectives on becoming successful leaders. Students benefit from this developmental experience focusing on professionalism.

## Studio D

*Ma Conversation avec Elle A Secular Country Emerging from Its Catholic History*

**Brady Gwynn - Georgia Southern University**

After the French Revolution, the Catholic Church and France's strained relationship created the secular state. This graphic novel explains the effects of the country's loss of faith, using George Perec's theory on the exterior versus the interior.

*The Validity of a Constructed Religion*

**Jacob Lancaster - High Point University**

In this presentation, the presenter uses Clifford Geertz and Mircea Eliade among others to define religion as a system constructed around a communal search for ultimate reality with a belief structure forming praxes for communion with this reality.

*Finding Faith in Honors: Liminal Spaces, Supreme Beings, and Cosmogonic Acts, oh my!*

**Rena Lubin - UNC Asheville**

As a Religious Studies major, I often get the question: why? Or the kicker: why are we stilllll talking about religion? However, elements of religiosity (whether we realize it or not) have been preserved across disciplines, cultures, and time.

## Studio E

*God is a Feminist*

**Aditi Prasad - Birmingham-Southern College**

While religion is seemingly the root cause of gender inequality, the issue is much more nuanced. Scriptural interpretation flips religious law into patriarchal mandate. I argue that religious doctrine itself is a powerful feminist tool.

*The American LGBT+ Literary Canon*

**Caitlin Stanfield - Cleveland State Community College**

The LGBT+ community has been subjected to erasure in literature. This presentation examines two queer canonical texts: James Baldwin's *Giovanni's Room* and Patricia Highsmith's *The Price of Salt* to move marginalized texts to the center of the canon.

*William Livingston: Defender of Faith and Freedom*

**Juliana Reents - Kean University**

First elected Governor of New Jersey, William Livingston was a fervent Presbyterian during a period of religious and political tumult. This paper explores his beliefs and how they convicted various areas of his life; politically and socially.

## Studio F

*Justice on the Edge*

**Dixie Sewell - Cleveland State Community College**

Restorative Justice, while on the edge of the justice system, is at the heart of social work. It focuses on rehabilitation for all parties involved. The combination of the two can bring about healing and reparation for the harmed and harmer.

*Nazi Kindergarten: Hitler's Training Tools for Children*

**Anna Patton - Francis Marion University**

Adolf Hitler used many types of anti-Semitic propaganda to brainwash Germany's children into hating the Jews. This presentation will exhibit research on the anti-Semitic propaganda Adolf Hitler used to mold Germany's youngest into adolescent Nazis.

The objective of this research is to understand how Black Studies courses at American institutions (specifically HBCUs) shape Black students' racial identity development and self-efficacy.

## **Poster Session**

**9:30AM to 11:00AM in Salon 5-7**

### **1) Comprehensiveness of Product Placement in Hollywood and Bollywood Movies**

Nikita Aangdembe Subba - Mississippi University for Women

*This presentation compares the comprehensiveness of product placement in movies from the Hollywood and Bollywood movie industries that share similar plot lines with each other from 2006 until 2015.*

### **2) Blood Brain Barrier, Neurovascular unit and Polymicrobial Systemic Sepsis Chantal**

Aaron - Ferrum College

*The disruption of astrocytes in the neurovascular unit underlies the three primary neurological effects seen in survivors of Systemic sepsis. The three primary neurological effects include cognitive decline, memory loss, and even depression.*

### **3) The cost of severity in a tale of two modes of delivery: Vaginal vs. C-section**

Abiana Adamson, Jonetta Mpofu, Elena Kuklina - Spelman College

*Cost burden of caesarean section (CS) hospitalizations complicated by severe maternal morbidity (SMM) has not been described. 33% of births were CD(caesarean delivery), but CD contributed 46% of total national cost for delivery hospitalizations.*

### **4) Ecology of a Border Wall: A Predator's Perspective**

Calvin Andries - Eastern Kentucky University

*This project investigates the impact of a border wall with Mexico by studying two endangered predators: Jaguars and the Mexican Gray Wolf. It analyzes how the perspective of a border wall affects them, and the ecosystems they call home.*

### **5) Clearcutting And Regeneration In A Forest**

Hunter Aycock - Ferrum College

*Intensive timber management practices like clearcutting have become commonplace in forests worldwide. The residual woody material left behind serves many uses that benefit the property and the surrounding ecosystem, when managed properly.*

### **6) The Impact of Thought Experiments on the Natural Sciences**

Anish Bachhu - Virginia Commonwealth University

*I am studying two thought experiments, Maxwell's Demon and Schrodinger's Cat because I want to comprehend how a scenario created mentally can affect the physical world.*

### **7) Sexual Strategies and the Evolution of Sexual Traits**

Samuel Baden - Pfeiffer University

*An investigation of sexual strategies and the evolution of sexual traits with two main questions being researched. How does mate selection differ between the sexes? And how does selection differ when choosing long-term versus short-term partners?*

### **8) Spatial Orientation by Landmark or Location: determination of preference for texture in the absence of visual cues**

Sara Baker, Tara Van Kleef - Georgia Southern University Armstrong Campus

*It is known that individuals orient themselves in two ways, either by cognitive mapping, or a physical landmark. In this study, these two methods were put in contrast to discover which individuals will chose when both disoriented and blindfolded.*

### **9) Dysfunctions of the Gliovascular Unit in Alzheimer's Disease**

Emily Barritt - Virginia Polytechnic Institute and State University

*The gliovascular unit (GVU) functions to maintain homeostasis in the brain. In Alzheimer's Disease the GVU is compromised. This research investigates the mechanisms by which this dysfunction occur to better understand the pathology of Alzheimer's.*

### **10) Creating Degrees of Freedom**

Sara-Lynn Bernard - St. Petersburg College

*The proposals idea is to create a non-invasive option for children with developmental orthopedic conditions. The project is to test early intervention with Kinesiotape and physical therapy to avoid surgical method for genu varum and genu valgum.*

### **11) The Psychology of Higher Level Performance in Elite Level Youth Soccer Players**

Matthew Best - James Madison University

*This study measures and evaluates the psychology of elite sport performance. A survey of over 4,000 male youth soccer players assessed psychological variables that were correlated to performance outcomes to better understand this relationship.*

### **12) Puzzling through Honors Branding: Putting Together the Pieces for the Honors Vision**

Sara Boone - The University of South Alabama

*I will organize a community event that will represent honors values while building the brand of the USA honors college. The formal with a murder mystery game will be based on research, and I will study the impression on attendees in a post-survey.*

### **13) Prevalence of Wolbachia in Local Populations of Cockroaches in the Southeastern US**

Brian Kohler - Georgia Southern Armstrong Campus

*The purpose of my study is to determine if the prevalence of Wolbachia infection in cockroaches varies by species and/or by their locations.*

### **14) Texture Properties of Activated Carbon Microspheres**

Bradley Brimmer, Kelly Badilla - University of South Alabama

*Using differing precursors and hydrothermal carbonization methods, activated carbon microspheres can be produced in a way that makes it easier for manufacturing while maintaining other literature values for the purpose of gas adsorption.*

### **15) The Cutting Edge or the Blunt End Fire Department Protocols in High Rise Operations?**

Nicholas Brondum - Eastern Kentucky University

*We will present our findings from a survey that we circulated among over one hundred and fifty American metropolitan, suburban, and rural fire departments on high rise firefighting operations.*

### **16) Profitability of Triple Exponential Moving Average in the Wheat Market**

Kassiady Buchanan - Murray State University

*Our purpose is to test the profitability of technical analysis in the commodity markets by determining the historic profitability of solely using a triple exponential moving average in the December Wheat market.*

### **17) Development of a Novel Object Recognition Test to Assess Memory and Learning in Danio rerio.**

Mary Carpenter - Georgia Southern University Armstrong Campus

*A Novel Object Recognition Test protocol was developed to test learning and memory in Danio rerio. The expression of memory-associated proteins, Akt and GSK3B, was analyzed to determine the effect of the NORT on biochemical aspects of memory.*

### **18) Can mainstream public employment programs and agriculture be a vehicle for effectively addressing gender disparities and promoting economic growth?**

Dorothy Carroll - Ferrum College

*Agricultural programs can be used as a vehicle to address pressing concerns among Americans.*

### **19) Characterization of the role of TRPM1 in mammalian pupil light reflex response**

Shane Chambers - James Madison University



*Intrinsic pupillary light reflex (PLR) has been shown to occur in mammals, while TRPM1 mice demonstrate a PLR defect. Recently, an intrinsic constriction pathway in the iris has been identified. We propose that TRPM1 helps mediate this response.*

### **20) Fabrication and Characterization of Mesoporous Protein Microspheres: Photosystem I Applications for Biohybrid Devices**

Madison Chan, Alexandra Teodor - University of Tennessee at Chattanooga

*This study focused on entrapping the biological component Photosystem I in protein microspheres for easier manipulation when developing biohybrid solar cells, which have a much higher potential efficiency than conventional solar cells.*

### **21) Virtual Reality-Based Training on Upper Body Movement and Activities of Daily Life in Older Adults with Parkinson's Disease**

Adanna Cheek, Dr. Donna Boyd, Dr. Cliff Boyd - Radford University

*Technology has assisted in the treatment of adults with Parkinson's Disease (PD). This study's purpose was to examine how the use of the Nintendo Wii Sports video game affected the upper body mobility and activities of daily life in adults with PD.*

### **22) The Influence of Three-Layered Cranial Architecture Development on Non-Accidental Pediatric Cranial Blunt Force Trauma Outcomes**

Kimber Cheek - Radford University

*This presentation documents development of the three-layered architecture of the juvenile cranium and investigates its effect upon pediatric Blunt Force Trauma (BFT) outcomes. These results have implications for preventing pediatric BFT mortality.*

### **23) Developing the American Democracy**

Samantha Clenney - Andrew College

*This presentation is based on the concept of how nations around the world each influenced the American way of life.*

### **24) A Study of Disclosure and Awareness**

Ryan Coleman, Tom Wilson - Bellarmine University

*Are we at all aware of our own implicit processes? This study is a recreation of an experiment that assumed their subjects were not aware of a priming effect to disclose information, with additional manipulations to challenge that assumption.*

### **25) Using Medical Illustrations to Bridge the Gap Between Health of Caucasians and Minorities in the US**

Kristen Connors - James Madison University

*US medical education lacks training on understanding genetically-diverse patients. This contributes to a disparity in wellness between Caucasians and minorities. I will address how diverse medical illustrations can help close this gap in health care.*

### **26) Creating a Veterans Memorial: A Service and Leadership Project**

Joshua Couch - Cleveland State Community College

*My poster portrays the decision making, servant leadership, and the goal setting skills that I gained from my Honors Leadership class to complete a Veteran's Day memorial for the American Legion banquet.*

### **27) Virtual Tai-Chi**

Christopher Davis - University of Tennessee at Chattanooga

*This project is designed to create an alternative means of rehabilitation through using a Virtual Tai-Chi environment created with sensors and a virtual reality headset.*

### **28) Synthetic studies to pyrimidodiazepine-based non-classical anti-folates as potential anti-cancer agents**

Dali Davis, Andrew Sennett - University of West Georgia

*We report on synthetic progress towards potential anticancer drugs via inhibition of folate requiring enzymes, starting from 2-amino-4,6-dihydropyrimidine using reductive cyclization chemistry as a key step.*

### **29) Redox Reactions in Near-Critical Water**

Nikolas Dos Santos, Dr. Heather Clontz - Wingate University

*An extensive study of redox chemistry in near critical water was performed using a non-stirring Parr reaction vessel. The studies focused on Baeyer-Villager oxidations using hydrogen peroxide/CO<sub>2</sub> and various substituted ketones.*

**31) Influence of environmental conditions on fatty acid-induced changes in Vibrio cholerae persistence and pathogenicity**

Abigail Doyle - University of Tennessee at Chattanooga

*Vibrio cholerae* can survive in brackish environments and the human intestinal tract. To assess the impact of environmental conditions on its pathogenesis, we cultivated the bacterium in a bioreactor using a design of experiments approach.

**32) Cytotoxicity of chalcones against Mia PaCa-2 cell lines**

Jacob Drescher, Amanda Krzysiak - Bellarmine University

A variety of molecules examining the flexibility and confirmation of a chalcone skeleton were screened for potential to affect proliferation of pancreatic cells. We found that constraining the ring has drastic negative effects on biological activity.

**33) Education Inequality: Causes and Solutions**

Elizabeth Elia - James Madison University

Educational systems have traditionally been unequal. In fighting for change, girls with disabilities are often overlooked. I will explore the causes of this educational inequality, and invisibility, as well as policy solutions to address the issue.

**34) An Honors Event: Murder Mystery Dinner**

Callie Elliott, Joy Smith - Gardner-Webb University

The Gardner-Webb Honors program has had the pleasure of conducting a murder mystery dinner for six years as it has proven to be one of our most popular events. The poster presentation will cover the planning, costs, and outcome of the event.

**35) Kindergarten Math and Language Arts YouTube SOL Resource**

Alexis Epperly - Radford University

My video resource can be used for Kindergarten students who need remediation in a specific SOL area, as well as, benefiting preschoolers by exposing them to Kindergarten SOLs; in hopes of making lasting connections and strengthening beginning skills.

**36) Crash and Burnout: The Sophomore Slump in College Athletics**

Jessica Ferguson - Gardner-Webb

The Sophomore Slump affects the lives of college student-athletes, especially their athletic performance, academic success, and relationship satisfaction. Potential techniques to help athletes in a slump are explored.

**37) The Impact of Abstract Expressionism in the World of Art**

Rachel Freeze - Pfeiffer University

Abstract expressionism challenged the art world by questioning what could be considered art. As a result artists in New York City focused on the processes, basic shapes, colors, and forms to express their feelings of vulnerability and irrationality.

**38) Morphological studies of three inhibitory interneuron types in the medial prefrontal cortex of Rett syndrome mice**

Rahul Gaini, Mary Phillips, Lucas Pozzo-Miller, Ph.D. - University of Alabama, Birmingham

To define the pathophysiology of the medial prefrontal cortex in autism spectrum disorders, we characterized different classes of inhibitory interneurons in Rett syndrome mice. Our findings indicate specific alterations in distinct interneuron types.

**39) Trematodes and Neorickettsia: diversity of Digeneans and their bacterial endosymbionts in mollusk first intermediate hosts from Mongolia**

Morgan Gallahue - Georgia Southern University

This survey of digenean trematodes from eastern Mongolia aims to identify species of digeneans present in the region as well as screen for the presence of the bacteria Neorickettsia, which is known to cause Potomac Horse Fever.

**40) Happily, Ever After?**

Samantha Gates - Catawba College

Consumption of Disney films and/or products begins at a young age and can carry over into adolescence and adulthood. This research examines its impact on college students and their feelings towards happy endings.

#### **41) Stem Assay in American Chestnut F2 Half-sibling and Full-sibling Families**

Kevin Gentner - University of Tennessee at Chattanooga

*The American chestnut is being threatened by an invasive fungal pathogen, Cryphonectria parasitica. This study contributes to research conducted by The American Chestnut Foundation in order to rescue the American chestnut from extinction.*

#### **42) Thermal and Rheometric Properties of Polymer Nanocomposite**

Olivia Goodson - James Madison University

*This study analyzes the effects of embedding light-emitting nanoparticles throughout a polymer matrix. Thermal and rheometric characterization were conducted on polymer nanocomposite samples at various mass loadings of the nanoparticles.*

#### **43) What "Enquiring" Minds Need to Know: How Marketers Infiltrate the Mind of a Consumer?**

Cecelia Gordon - St.Petersburg College

*As a consumer, you are probably wondering how marketers and brands influence your mind? They study trends and human psychology, use pathos and ethos, aim to make you feel important, and even use color psychology as a strategy to attain your business...*

#### **44) The Hurt of Appalachia: What has society done to us?**

Cassie Green - Southeast Kentucky Community & Technical College

*What do you think of Appalachia when you hear it? Justified, or hillbilly, or Mountain Dew mouth? Media and entertainment in society has put forth damaging stereotypes of the Appalachian area for too long, and they should be confronted.*

#### **45) Localization of phosphorylated AMPK during cell migration using immunofluorescence**

Valerie Griesche, Chandler D. Williams, Melissa M. Fox PhD - Wingate University

*AMPK is a tumor modulating protein that plays a role in cell migration. MDA-MB-231 breast cancer cells show increased migration after AMPK activation and immunofluorescence staining reveals re-localization of pAMPK $\alpha$  to the leading edge of the wound.*

#### **46) Honors Congress: A Social Outlet for High Achieving Students**

Michele Guillard, Samuel Mikhail, Samantha Berg - University of Central Florida

*Honors Congress is the Official Student Organization of the Burnett Honors College at the University of Central Florida which provides an outlet for students to come together and explore new things together as a part of an extracurricular experience.*

#### **47) What Does it Mean to "Dream Big, Princess": A Rhetorical Analysis of Disney's Princess Identity and Ideology**

Brianne Habit - Randolph-Macon College

*This poster presentation analyzes the ideology and identity of the Disney Princess, through the verbal and visual rhetoric of 11 Disney Princesses, including their films and the associated website content of the Disney website.*

#### **48) Smart Cities: The Overview**

Kendra Hale, Sam Bair, Owen Pilewski, Neil Slinde, Haley Scaggs, Elise Holford, and David Qin - Virginia Polytechnic Institute and State University

*Disruptions are occurring around technologies, ubiquitous computing and artificial intelligence. This analysis describes the areas in which a city can become 'smart' and what is required for those areas to advance with intelligent technology.*

#### **49) Effectiveness of Alternative Therapies for People with Special Needs**

Emily Hamilton - Gardner-Webb University

*This research examines the effectiveness of alternative therapies - play, art, music, horticulture, and animal-assisted - in helping various special needs populations with a focus on animal-assisted therapies.*

#### **50) Effects of Royal Jelly in Combination With Juvenile Hormone Agonists and Antagonists on Drosophila melanogaster**

Taylor Hawkins, Justin Archer, Jason Davis - Radford University

*We studied the impact of Royal Jelly (RJ) in combination with juvenile growth hormone (JH) on both larval and adult fruit flies (Drosophila melanogaster) to report effects on morphology, developmental time course, and mortality.*

### **51) Stress in College Students**

Kristen Higgins - Murray State University

*This investigation examined the correlates of stress in college students. Participants completed questionnaires about their personality, social relationship satisfaction, stress, and self-efficacy. Results and implications will be discussed.*

### **52) UWG Ceramics SRAP- Kiln, Clay Body, and Glaze Exploration**

Kaitlyn Hollis, Jeanne Abernathy - University of West Georgia

*UWG's SRAP research for 2018 encompasses the exploration of building a soda/salt kiln, testing 5 clay bodies, and producing over 100 possible clay and glaze combinations in an easily accessible visual display + recipe catalogue.*

### **53) Central Nervous System Sensitization is Associated with Chronic Pain in HIV**

Tyler Huang - University of Alabama, Birmingham

*Analysis revealed that people living with HIV and chronic pain exhibit greater central nervous system sensitization in comparison to people living with HIV without chronic pain according to temporal summation of various pain testing apparatus.*

### **54) The U.S. Experience Economy: Understanding Our World**

Victoria Jackson - Pfeiffer University

*The Experience Economy, a term coined by Pine and Gilmore, provides insight into the new era of the American Economy. Looking at past trends and current consumer demands, experiences could potentially become the primary driver of the future economy*

### **55) Comparative Analysis of Pensacola Bay Area Rain Water**

Jade Jacobs - University of West Florida

*Research regarding the rain water and air quality of the Pensacola Bay area of northwest Florida was conducted over the months of May-July of 2017. Quality factors were analyzed over the following months and compared to data from a previous study.*

### **56) The Toxic Effects of Carbaryl: Analyzing Brain and Behavioral Effects in C57BL/6J Mice**

Jillian Jay, Dr. Abby Meyer, Dylan Beckham, Anna Knight, Raina Davis - University of North Georgia

*We tested whether carbaryl (a common household pesticide) could induce anxiety and depression in mice.*

### **57) Toxicity of Iron-Oxide Nanoparticles in an in vivo Setting**

Mariah Jensen-Wachspress - University of Mary Washington

*These NPs are a potential treatment for an aggressive brain cancer and it is important to map their clearance from the point of injection and their toxicity in an in vivo setting.*

### **58) Designing with Empathy: The Millennial Office**

Madeline Johann - Radford University

*The designer's job is to gain empathy for their clients to achieve the desired result. Millennials have new standards for their work environment. This study identifies the trends in office design through a content analysis of top corporate projects.*

### **59) The Relationship between Masculinity and Stigma: Predicting Help-Seeking Behaviors in Men**

Bethany Johnson - Georgia Southern University

*Based on the stigma associated with men's mental health, the purpose of this ongoing study is to gain knowledge of help-seeking behaviors in men while evaluating the influences of masculinity and stigma on these help seeking practices.*

### **60) Characterization and Genome Annotation of the Novel Mycobacteriophage Phranny**

Clare Johnson, Bush, A.M, Knox, A.M., and Peyton, D.K. - Morehead State University

*The research I have been doing is on bacteriophage discovery and identification. This was done using the PECANN software. We used different databases such as NCBI BLAST and Phagesdb BLAST to narrow down the possible function of the gene.*

### **61) Establishing An Apiary At A Medium Sized University**

MacKenzie Jones - Murray State University

*Our objective is to illustrate the steps we took to establish the Murray State University Apiary, and to educate on the importance of preserving this species.*

### **62) The Effect of Visual and Information Website Design on User Frustration**

Hannah Laubler - University of North Georgia

*Perceived frustration is an attribute that hasn't been touched in many website design studies. The goal of this study is to see if visual and information design of a website can influence perceived frustration.*

### **63) p53 Protein Reactivation – A Promising Approach in Fighting Cancer**

Phoebe Le - Columbia College

*Have you been wondering what are some of the current advances in our fight against cancer? Come to our poster presentation and learn about p53, "the guardian of genome," and its promising applications in curing cancers in human.*

### **64) Henry Reaction Catalyzed by Enzymes**

Khareem Leslie, Raihaanah Hutson - University of West Georgia

*The Henry reaction is a powerful way under mild conditions to obtain  $\beta$ -nitroalcohols, that are versatile building blocks natural product synthesis. We propose to enhance the reaction with enzymes so as to shorten the reaction time.*

### **65) Drawing the Lines of Gun Control: A New Interpretation of an Old Amendment**

Benjamin Lindquist - University of West Florida

*The Second Amendment includes the right of individuals to possess arms for self-preservation, but where does that right end? Our research lead to the interpretation that this amendment wholly protects unhindered access to arms, barring only WMDs.*

### **66) Use of Veterans Specific Activity Questionnaire (VSAQ) to Predict Exercise Tolerance in Ambulatory Amyotrophic Lateral Sclerosis (ambALS) Patients**

Patrick Mabe - Pfeiffer University

*There is currently no protocol that outlines exercise dosage based on individual ALS patients. We have validated the VSAQ with other outcome measures and have concluded that it is effective in estimating exercise tolerance in this population.*

### **67) The Effects of Mood and Music on the Implantation of False Memories**

Tyler MacDonald - Coastal Carolina University

*The purpose of this experiment was to study the effects that mood and background music have on the implantation of false memories.*

### **68) Corporal Punishment and Media Violence as Risk Factors for Aggression**

Alexzondra Mattson - Ferrum College

*This presentation examines the significance of corporal punishment and media violence consumption as risk factors for aggression in youth. Empirical research reveals a correlation between corporal punishment, media violence, and aggression.*

### **69) The Analysis of p53 Mutation Associated with Cervical Cancer Susceptibility**

Jessica McNeill, Taylor Broach - Francis Marion University

*The aim is to analyze the association between p53 polymorphism and with cervical cancer susceptibility. This experiment investigates the polymorphism in codon 72, which efficiently degrades the Arg-type gene product of p53 by the HPV E6 oncoprotein.*

### **70) How Do We Serve?: The Research of Deliberate and Focused Attention**

Rachael Meachem - Gardner-Webb University

*Studied the ongoing war against poverty at Graham Elementary School in Shelby, NC. The primary sources included interviews with Graham Elementary staff, field observations, and literary work from authors who have spent years on research.*

### **71) Structural Affinity of CAP1 and AC isoforms**

Simran Mehrotra, Maria Eugenia Sabbatini - Augusta University

*Adenylyl cyclase-associated protein 1 (CAP1) regulates cell migration and invasion. We studied the relative affinity of CAP1 for AC1, AC3, AC4 and AC7. AC1 is the isoform that interacts more firmly with CAP1 in HPAC and PANC-1 cells.*

### **72) Socioeconomic Effects of the Japanese Idol Industry**

Kayleigh Meier - St. Petersburg College

*The Japanese idol industry is billion-dollar international business that monopolizes on the exhibition of young, developing females and sometimes males. Over the years, they have become an important contributor to economic and social developments.*

### **73) Prosthetics is a multidisciplinary field of technological advancement that has yet to catch up with its evolutionary biological counter-part.**

Alirio Mijares - Broward College

*Current advancements in the field of prosthetics, including new technologies and approaches to developing artificial limbs and organs as well as ways of incorporating them into the human body.*

### **74) The Impact of Community Factors on Child Abuse and Neglect at the County Level**

Kate Mobley - University of Tennessee at Chattanooga

*Rates of child maltreatment of counties were compared to demographic aspects. Statistical analyses were used to find the strongest correlations. Strain theory, General Strain Theory, and the Theory of Anomie were used to explain relationships.*

### **75) Restoring the American Chestnut**

Quentin Montgomery - Ferrum College

*The American chestnut was once a dominant tree species in the eastern U.S. until the chestnut blight fungus was introduced. The two major methods for restoring the American chestnut are hybridization and biological control.*

### **76) Faulknerian Social Strata Meridians in Yoknapatawpha County**

Margaret Owens - University of North Georgia

*The increasingly-popular field of literary cartography has opened up a new realm of study within Faulknerian criticism that reveals the classic characters who inhabit Yoknapatawpha County to occupy a deeper space in the canon of modernism.*

### **77) Nutrition in The American Prison System**

Matt Pankey - Cleveland State Community College

*My poster presentation will examine the nutrition plans in place in the American prison system. The project takes a deeper look into the meals prepared, the effects it has on the inmate's health, and ways we can improve their diets.*

### **78) Writing a Healthcare Bill**

Andrew Parr - James Madison University

*This study compares healthcare systems in the U.S. and in select foreign countries, seeking to identify aspects of existing policies both domestically and internationally that are most effective in delivering quality healthcare at affordable cost.*

### **79) Story, Not Formula: A Comparison of the Creative Fiction and Historic Nonfiction Writing Processes**

John Payne - Pfeiffer University

*To compare and contrast the process for writing creative fiction and writing historic nonfiction, I generated several pieces of flash fiction and short stories. I then submitted these for publication.*

### **80) Indecision Is a Decision Within Itself**

Leilani Porter - James Madison University

*Decision making is a vital process that requires identification of the problem, data collection strategies, weighing and assessing evidence, and thinking from various perspectives. When decisions are made, we must stand behind them.*

### **81) The Evolution of LGBTQ Representation in Video Games**

Miles Poteat - Catawba College

*This presentation analyzes the evolution of LGBTQ representation in the realm of popular video games, where the industry is lacking, and where we should go from here.*

### **82) Imparting A. nidulans with Fungicide Resistance via Overproduction of the AtrB Subunit of an Efflux Protein Pump**

Kaley Powers - Georgia Southern University Armstrong Campus

*In this project, we genetically manipulated a non-pathogenic strain of the fungus A. nidulans to overproduce a subunit of an efflux pump, giving it fungicide resistance.*

### **83) The Effects of Equine Assisted Learning on Emotional Intelligence Competencies and Leadership Skills**

Jade Rauen - Eastern Kentucky University

*A survey was given to 32 participants of an Equine Guided Leadership Education workshop. A thematic analysis of the responses followed. Results indicated that EAL may be an effective means of developing EI competencies despite demographic factors.*

### **84) Cellular Rreprogramming of Medium Spiny Neuron Subtypes Using the CRISPR-dCas9 System**

Jasmin Revanna, Katherine Savell, Jeremy Day, Ph.D. - University of Alabama, Birmingham

*The goal of this project is to use the CRISPR-dCas9 system to identify the transcription factors that regulate programs that establish the major 2 classes of medium spiny neurons in the striatum: Drd1 & Drd2 dopamine receptor possessing neurons.*

### **85) Designing a Thoughts, Values, and Beliefs Course for Non-Computer Science Students on Artificial Intelligence and Its Potential Societal Impacts**

Vincent Rollins - University of Tennessee at Chattanooga

*This research reviews the literature of the fields involved in artificial intelligence and decides what collection of reading/film assignments best covers the necessary information when it comes to conveying the widespread impacts of AI to students.*

### **86) The Effect of Dietary Restriction on Saccharomyces cerevisiae Lifespan**

Katie Rouse - University of Tennessee at Chattanooga

*Here we investigate the effect of dietary restriction on replicative lifespan of gene deletion strains in Saccharomyces cerevisia. We fit the data with aging models to find association factors in genotype-dependent responses to calorie restriction.*

### **87) Hybrid Layer Stacks for 1D Photonic Crystals**

Nazaret Sarahn, Amber Ethridge, Ajith Desilva - University of West Georgia

*1D photonic crystals can be constructed using alternating thin layer stacks of organic tris (8-hydroxy) quinoline aluminum and inorganic titanium dioxide. A high refractive index difference allows greater reflectivity with fewer periods.*

### **88) The Effects of Diet on the Evolution of Salivary Alpha-Amylase**

McKenzie Schrank, Dr. Jason Davis - Radford University

*This research examines the evolutionary effects of alpha-amylase and diet. Peruvians and North Americans were studied, and each participant provided a dietary survey and saliva. North Americans were studied before and after Peruvian-typical diet.*

### **89) Species Richness in Oyster Pond, San Salvador, Bahamas**

Alex Schwartz - University of Tennessee at Chattanooga

*I performed biological surveys of the organisms living around the cave conduits of Oyster Pond on the island of San Salvador, Bahamas. Additionally, I surveyed the conditions of the conduits themselves and compared their species richness.*

### **90) Protein Partners of Allelic Variants in the mTOR HEAT Domains**

Amanda Sciorillo - Marymount University

*The mammalian target of rapamycin (mTOR) has been linked to tumor growth. The purpose of this study is to elucidate the functional significance of HEAT repeats and show allelic variation in the HEAT repeats may contribute to tumor susceptibility.*

**91) The Edge of Holistic Therapy: A Meta-Analysis on Meditation's Role in Cancer Treatment**

Dakota Shively - Eastern Kentucky University

*Cancer is one of the deadliest diseases the world faces in the 21st century. Meditation therapy, recently rising in popularity, has been researched to positively impacting patients, but to what extent could meditation have in treating symptoms?*

**92) Speech Recognition Errors: Implications for Aging**

Rachel Short, Kimberly G. Smith, PhD, CCC-SLP - University of South Alabama

*This study examined sentence recognition of spoken information in interrupted and steady-state noise in normal hearing older adults. For interrupted noise, proportion of signal preservation was critical. No difference emerged between the noise types.*

**93) Quantitative Analysis of mRNA Expression in Endogenous and Exogenous CFTR Expressing Cell Lines**

Lisa Shrestha - Mississippi University for Women

*This project aims to determine relative mRNA expression levels of cell lines that express CFTR endogenously and exogenously by Real-time PCR to provide data that will allow others to use RT-PCR as an analytical tool in the clinical diagnosis of CFTR.*

**94) Learning Compassion Through the Performing Arts**

Orr Sierra - James Madison

*University Music and theatre are crafts that teach compassion through physical action and witnessing. This project seeks to design music and theatre education programs that embody compassion and empathy and address the needs of the whole community.*

**95) Disease Gene Discovery for Microcephaly in Consanguineous Pakistani Families**

Vattika Sivised - Augusta University

*The paper explores four consanguineous families displaying X-linked autosomal recessive microcephaly. For two, there is a defect in the ASPM gene. Candidate genes, including SCN7A, can cause the phenotype in the remaining two and will be discussed.*

**96) The Appalachian Dilemma: The Just Distribution of Health Care Regarding Genetic Modification and Enhancement**

Haley Sizemore - Eastern Kentucky University

*This author argues that without government regulation of the distribution of genetic modification, the poor of Appalachia will suffer immensely from the lack of protection and will eventually fall further behind more developed and wealthy areas.*

**97) Supporting ELL Students and Their Teachers**

Abigail Slattery - Georgia Southern University

*This case study research investigates the support being offered to English Language Learners and their teachers in a rural, southeastern Georgia public elementary school in order to expand on the limited research regarding this population in these types of environments.*

**98) The Relationship Between Christianity and PTSD Shown Through 19th- and 20th-Century Literature**

Allyson Smith - Augusta University

*This project demonstrates whether a return to faith as a coping mechanism can be an effective strategy for the modern individual struggling with PTSD by integrating context from two fictional works, one from the 19th and one from the 20th centuries.*

**99) A walk in Thomas and Corey's shoes: My personal account regarding the differences involved in raising a healthy child, and one born disabled.**

Leslie Stacy - Southeast Community and Technical College

*The daily lives of my boys are similar in ways, with one significant difference. Because of his cerebral palsy, Corey's day is always a bit rougher than Thomas's. Walking a day in Corey's shoes is never easy, but looking at him, you'd never know it.*

**100) Improvements in Alternative Fuel Internal Combustion Engine Efficiency by using Water Injection**

Connor Strawn - University of Tennessee at Chattanooga

*To combat the inherent disadvantages of alternative internal combustion fuels, water injection can be used. A retrofitted engine with water injection will be tested, with the results allowing a comparison with gasoline benchmarks.*



**101) Psychosocial Well-Being and Efforts to Quit Smoking in Pregnant Women of Rural Appalachia**

Brittney Stubbs, Andrea Clements, Valerie Hoots - East Tennessee State University

*Stress, self-esteem, depression, and disordered eating were analyzed among three groups of pregnant women in Tennessee Intervention for Pregnant Smokers (TIPS): never smoked, smoked but quit prior to birth, and smoked but did not quit prior to birth.*

**102) Race-Specific Factors Play a Significant Role in Modifying Overall Survival for Primary Lung Cancers**

Lakshmi Subramani - University of Alabama, Birmingham

*Disparities in the overall survival rates (OSRs) of primary lung cancer patients exist. But, it is unclear whether factors linked with OSR differ by race. Our study tried to determine if there are racial differences in the factors linked with OSR.*

**103) Fake News: Agenda Setting and Gatekeeping in the Media**

Chelsea Sydnor - Gardner-Webb University

*This project examines the theories of agenda setting and gatekeeping and how they affect the modern media. Also, it will analyze the concept of 'fake news' and the Russian ads and their effect on the results of the 2016 U.S. presidential election.*

**104) Feminist Cosmo: An Analysis of Cosmopolitan Magazine Surrounding the Heights of Feminism**

Emily Szalkowski - Gardner-Webb University

*Women's magazines have developed over time, accompanied with the rise of the feminist movement. The purpose of this study is to examine how Cosmopolitan Magazine's changed in content due to the impact of the heights of feminism.*

**105) Heavy Metal Detection Through the Reactive Dye Method and Natural Fiber Welding**

Amanda Tanner, Savannah Hoyt - University of South Alabama

*Rapid heavy metal detection in aqueous systems can be achieved via the reactive dye method and natural fiber welding. Together these processes create test strips containing chemodosimeters which produce fluorescent response when introduced to metals.*

**106) Coresidence Patterns and Family Caregiving in Japan**

Julia Thomas - Georgia Southern University

*In Japan there is a growing problem of how to care for the expanding Japanese elderly population. This poster will discuss Japanese coresidence patterns and caregiving as these relate to improving the quality of care for Japan's elderly population.*

**107) Biodiesel Production in 3D Printed Microreactors**

Cooper Thome - University of Tennessee at Chattanooga

*This study aims to provide a proof of concept for the use of stereolithographic (SLA) 3D printed microreactors for continuous flow biodiesel production. Evaluated areas include material compatibility, printing precision, and design performance.*

**108) Synthesis of Oxidative Metabolites of the Environmental Contaminant DEHP**

Hoang-Anh Tran - University of Mary Washington

*Synthesis of three main metabolites: 2-carboxy MMHP (1), 5oxo-MEHP (2), and 5-carboxy MEPP (3) of Diethylhexylphthalate is necessary to understand the biological effect of phthalates.*

**109) Factors influencing age of first sexual encounter**

Allison Usry - Ferrum College

*The study looked at race, family structure, parents' education level, and socioeconomic status individually and determine which one(s) have the strongest correlation with age of first heterosexual, vaginal intercourse.*

**110) Chica Traducida: Subalternity and Cultural Erasure in the Translation of The House on Mango Street**

Jessica Vaught - Eastern Kentucky University

*In The House on Mango Street, author Sandra Cisneros claims Chicana subjectivity by writing a text profiling Chicana adolescence and sexuality, but Spanish translator Elena Poniatowska enforces subalternity as she co-opts the text by poetic license.*

**111) Images of Feminist Protest: The Negative Effects of the Media on the Women's Liberation Movement**

Elizabeth Von Mann - Morehead State University

*The protests and activism for Women's Liberation of the 1960s and 70s became defining images for the modern feminist movement. The media's representation of the 60s and 70s feminist movement was a key factor in how the country came to view feminism.*

**112) The Fifty-First State: How Americanization Through the Military Transformed South Korea's Politics and Culture**

Grace Welsh - Augusta University

*This paper investigates the effects of Americanization through militarization from the Korean War on Korea's military and culture. Current examples of Korean pop culture will be used to explain localized American influences on the military.*

**113) Diversity Amongst Law Enforcement Along the U.S.-Mexico Border**

Lisa Wier - Eastern Kentucky University

*Out of the twenty-two U.S. counties residing along the Mexican border, around half of them have Hispanic sheriffs. This poster will show how diversity in law enforcement, in regards to border counties, effects its relations with locals and migrants.*

**114) The influence of localized ecological variables on southern Appalachian salamander populations**

Jasmine Williamson, Kayla Allen, Cory Duckworth, Todd Bennett, Kaitlin Shook, Dr. David Patterson, Jessica Patterson - University of North Georgia

*Northeast Georgia is an important region in studying sensitive amphibian populations due to locally elevated diversity. We utilized pitfall traps to investigate effects of biotic and abiotic factors on salamander diversity and ecological dynamics.*

**115) The Perceived Size of the Rim Can Affect How Many Free-Throws Are Made**

Nicholas Wright - Georgia Southern Armstrong Campus

*Based on a study by Witt and Dorsch (2009), we examined the relationship between action and perception in motor activities, such as shooting a basketball.*

**116) An Analysis of Human Trafficking in the Southeastern United States: Improving Enforcement and Training**

Katherine Wyant - Eastern Kentucky University

*This research presents an analysis of human trafficking in the southeastern region of the US. Findings highlight the need for continued emphasis on victim-centered tactics, as well as focused law enforcement efforts towards those financing the crime.*

**117) I'll Take My Artifacts with Tea: Nineteenth and Early Twentieth Century British Archaeology in Mesopotamia**

Rachel Young - Augusta University

*This project analyzes the research done by British archaeologists in the nineteenth and early twentieth centuries in Mesopotamia, as well as their interpretations, reasons, and motivations for research.*

**118) Thermal stress in artificial cavity-nesting Eastern Bluebirds: killing them with kindness?**

William Zahran, Dr. Susan McRae - East Carolina University

*Eastern Bluebirds breeding in nest boxes in North Carolina may be experiencing thermal stress that negatively affects their reproductive success. This research examines a possible downside of nest boxes, an important tool in bird conservation.*

**119) Assessment of the Reusability of Microdevices by Conducting Binding Studies using Anti-CD71**

Cat Zwemer, Eric Hurwitz - University of Mary Washington

*Microfluidic devices are used for their capabilities in immobilizing cells and inducing cellular separations. The reusability of each device was assessed by measuring the binding efficiency using various reagents to clean the channels of the devices.*

## Session K - 9:15AM to 10:15AM

### Studio A

**RESEARCH PANEL:** Living on the Edge of Mental Health

**Angela Mick, Ilse Ulloa Cruz, Tamir Makev, Davidson Mesquita Neves, Colby Ryan - Hillsborough Community College**

Understanding mental health can influence how to manage time and incorporate a balanced lifestyle. Join us in exploring mental health challenges students face and how preventative measures can assist to manage mental health.

### Studio B

*Rereading The Scarlet Letter: An American Romantic Tragedy*

**Sydney Rice - Murray State University**

In my paper, I argue that in *The Scarlet Letter*, Hawthorne knowingly manipulates the characteristics of tragedy to create a new form--the American Romantic Tragedy--with an empowering female character, Hester Prynne, as the traditional tragic hero.

*The Grotesque Self: Finding Identity through the Grotesque in the Works of Carson McCullers*

**Colton Greganti - University of Tennessee at Chattanooga**

I will analyze how elements of the grotesque in Carson McCullers's *The Heart is a Lonely Hunter* and *The Ballad of the Sad Café* enable her female characters to create a new sense of self and highlight the oppression of the southern woman.

*A Modern Understanding of Mental Illness in "The Yellow Wallpaper"*

**Kiera Young - Wingate University**

Charlotte Perkins Gilman's "The Yellow Wallpaper" demonstrates the dark side of women's mental health treatment in the 1890s, in which treatments and diagnosis would not meet today's standards.

### Studio C

*Exercise performance and mental toughness in task vs. time oriented exercise bouts.*

**Logan Evans - Lynchburg College**

The aim of this study was to examine the differences in performance in task and time-oriented running bouts with a secondary aim to examine relationships between performance and levels mental toughness.

*Arch Form and Function Effects on Knee Pain in Collegiate Track and Field and Soccer Athletes*

**Bishop Morgan, Dr. Laura Gruss, Cassidy McRorie, Richard Gruss - Radford University**

The goal of our study was to test for a correlation between foot structure and function and knee pain in male and female soccer and track and field athletes. Female soccer players and those with more planus and supinated feet had the most knee pain.

*The Physical-Psychosocial Cycle of Dancers: A Critical Look at Why Dancers Suffer from Such High Injury Rates*

**Rachel Smith - University of Tennessee at Chattanooga**

Dancers are injured at a higher rate than others due to the emphasis on perfection that builds psychological stress. The Physical-Psychosocial Injury Cycle theory developed in this study can be used to discover how to break the cycle and lower rates.

## Studio D

*The “Three Graces” of William Livingston*

**Leanne Manna - Kean University**

This presentation explores the role of women in late 18th-century America and the extent to which they influenced society and the revolution through the example of the Livingston women.

*Student Participation in Higher Education Governance: An Elusive, Unexplored, Enigmatic, and Unaddressed Subject of American Higher Education*

**Anthony D’Andrea - Marymount University**

If students play a role in higher education governance, does this have an affect on institutional outcomes? It is hypothesized that when university committees include students as members, than the rate of institutional retention will increase.

*Building Community through Dialogue: An Oral History Project*

**Kristy Clark - Valdosta State University**

Honors students have collected oral histories of individuals from diverse social and religious groups on campus in order to reveal common themes across race, ethnicity, and religious boundaries using food and social rituals.

## Studio E

*Drowning in Possibility: A Rhetorical Analysis of the Existing Pool of Knowledge Surrounding Aquatic Safety Education*

**Sierra Diemer - Georgia Southern University Armstrong Campus**

A rhetorical analysis of “aquatic safety” as a commonplace metaphor conceptualized and perpetuated by the general public into dominant ideology. The study suggests that, to create effective policy, terms must be destabilized through rhetorical means.

*The Case of Odysseus and Beyond: Healing through Storytelling*

**Lauren Estell - Randolph-Macon College**

Storytelling works as a method of healing both in the general sense and with combat veterans suffering from PTSD in particular. The research presentation depicts an analysis of storytelling and its use in historical and modern context.

*What’s a “Man”? A Discussion of Identity in Pat Conroy’s The Lords of Discipline*

**Elijah Melendez - The Citadel**

The Lords of Discipline explores the journey of Will McLean – a cadet at the Carolina Military Institute – as he struggles to find himself. This presentation analyzes the relationships and situations which influence the character’s identity.

## Studio F

*3D Printing an Optically Transparent Part for Use in Sensors*

**Hiroshi Yanagida - University of Tennessee at Chattanooga**

The purpose of this presentation is to demonstrate a proof of concept that the optical properties of nanoparticles can be utilized for 3D printing sensors.

*Breaking Borders: The Case For a Universal Electronic Medical Record System in America*

**Quinton Fallon , Emily Summers, Anthony Noll - University of West Florida**

This presentation will examine the possibilities of having a universal EHR, or Electronic Health Record, a system for all healthcare groups in America.

*Stochastic Simulation: An Introduction to Random Variables, Asset Pricing, Stopping Points, and Optimized Portfolios.*

**Alec Gilliam - Virginia Polytechnic Institute and State University**

Most events that can be expressed mathematically have a random element; for example we present an Asset Pricing Model. Simulations of its Stochastic Differential Equation predict future values and can optimize portfolios to reduce investment risk.

## Session L - 10:30AM to 11:30AM

### Studio A

**RESEARCH PANEL:** *Scripting History; A Revolutionary Wedding Brought to Life*

**Juliana Reents, Samantha Bernardi, Matthew Griffin, Tyler Kerekgyarto, Christopher Perez, Sarah Roberts, Josue Simao, Megan Tobias - Kean University**

Kean Honors students present an original script written for the upcoming historical reenactment of John Jay and Sarah Livingston's wedding in New Jersey. Following the script reading, a discussion will explore their research and writing process.

### Studio B

*A Study in Cultural Competence*

**Carly Mathis - Georgia Southern University Armstrong Campus**

This presentation will highlight a case study in which interview data is used to examine the applicability of Hofstede's (2011) cultural dimensions to the development of cultural competence among speech-language pathologists in clinical practice.

*All These Noises Have Us Feeling Puzzled*

**Sabrina Pratt - Murray State University**

In the present study, the relationship between learned helplessness and urban noise pollution was explored. Results supported the hypothesis that when humans are exposed to uncontrollable noise, they show learned helplessness characteristics.

*On the Edge of the Hearing World*

**Katelyn Wheeler - Seminole State College**

In today session, there will be discussion about how the hearing world is something deaf people struggles to be a part of and there are obstacles that they must overcome. The solution is proposing the idea of sign language as a bridge to both world.

### Studio C

*The Effects of Cognitive, Nutritional, and Environmental Factors on Prenatal Development*

**Lindsay Higgins - Birmingham-Southern College**

Although the United States is a developed country, poverty as well as lack of access to prenatal and obstetrical care and educational differences still exist. As a result, varying factors have lasting effects on the development of the child.

*Extracellular Ubiquitin Modulates Inflammatory Response Following Myocardial Ischemia/Reperfusion Injury*

**Kristina Lim - East Tennessee State University**

Heart disease is the leading cause of death in the U.S. Myocardial ischemia/reperfusion injury triggers an inflammatory response which can contribute to heart failure. We found extracellular UB has a protective anti-inflammatory role in this injury.

*An in vitro Analysis of the Relative Efficacies of Antibiotic Solutions vs. Antiseptics in Breast Augmentation Surgery*

**Victoria Noyes - University of Tennessee at Chattanooga**

This study examines the antiseptic chlorhexidine gluconate as a more effective alternative to the standard triple antibiotic irrigation solution used to prevent bacterium-associated infection and lymphoma following breast augmentation surgery.

## Studio E

*Disturbed Sleep Patterns due to Stress Related to Nursing School: a Correlation Study at Armstrong State University Nursing Program*

**Courtney Sanderlin - Georgia Southern University Armstrong Campus**

This study examines a potential correlation between increased stress levels and disturbed sleep patterns in undergraduate nursing students. A potential correlation was found and several nursing interventions are described.

*Effects of Post-Weaning Mat-Feeding Frequency on Piglet Health and Performance*

**Margaret Nagai, Emalee Buttrey - University of Tennessee at Martin**

The objective of the current study was to evaluate effects of the daily frequency of mat-feeding on piglet performance and health. Estimated feed consumption, feed efficiency and health were similar among all treatments ( $P \geq 0.18$ ).

*Tennessee Governor's School for the Agricultural Sciences and its Effects of Students of Varying Backgrounds*

**William Singer - University of Tennessee at Martin**

The goal of this project is to determine the impacts of Tennessee Governor's School for the Agricultural Sciences on participating students' educational pathways. Both students with agriculture and non-agriculture backgrounds will be interviewed.

### **SRHC Closing and Reflection**

**12:00PM to 12:30PM in Salon 1-4**

### **Partners in the Parks™ Gathering for Departure**

**12:30 to 1:00PM in Salon 1-4**

### **SRHC Executive Committee Meeting**

**12:30 to 1:30 in Studio C**

### **VCHC Executive Committee Meeting**

**12:30 to 1:30 in Studio A**